



**TAILORED**  
**SOLUTION**  
HYGIENE BEST PRACTICES

# RAISE THE HYGIENE STANDARDS OF YOUR BUSINESS

Through this manual, Papernet has prepared a hygienic-professional journey aimed at guaranteeing highly personalized solutions able to ensure protection and safety in all work environments.



**HEALTH CARE**

“

**A real Customer Journey  
that will help professionals  
in Health Care to guarantee  
the best quality standards  
in terms of hygiene and increase  
the value of services  
within their organizations.**



# READY AS ALWAYS TO DO OUR PART.

**Papernet is sustainable hygiene.** With this **recommendations and solutions manual**, Papernet provides a valid support **to make every working environment even more hygienic.**

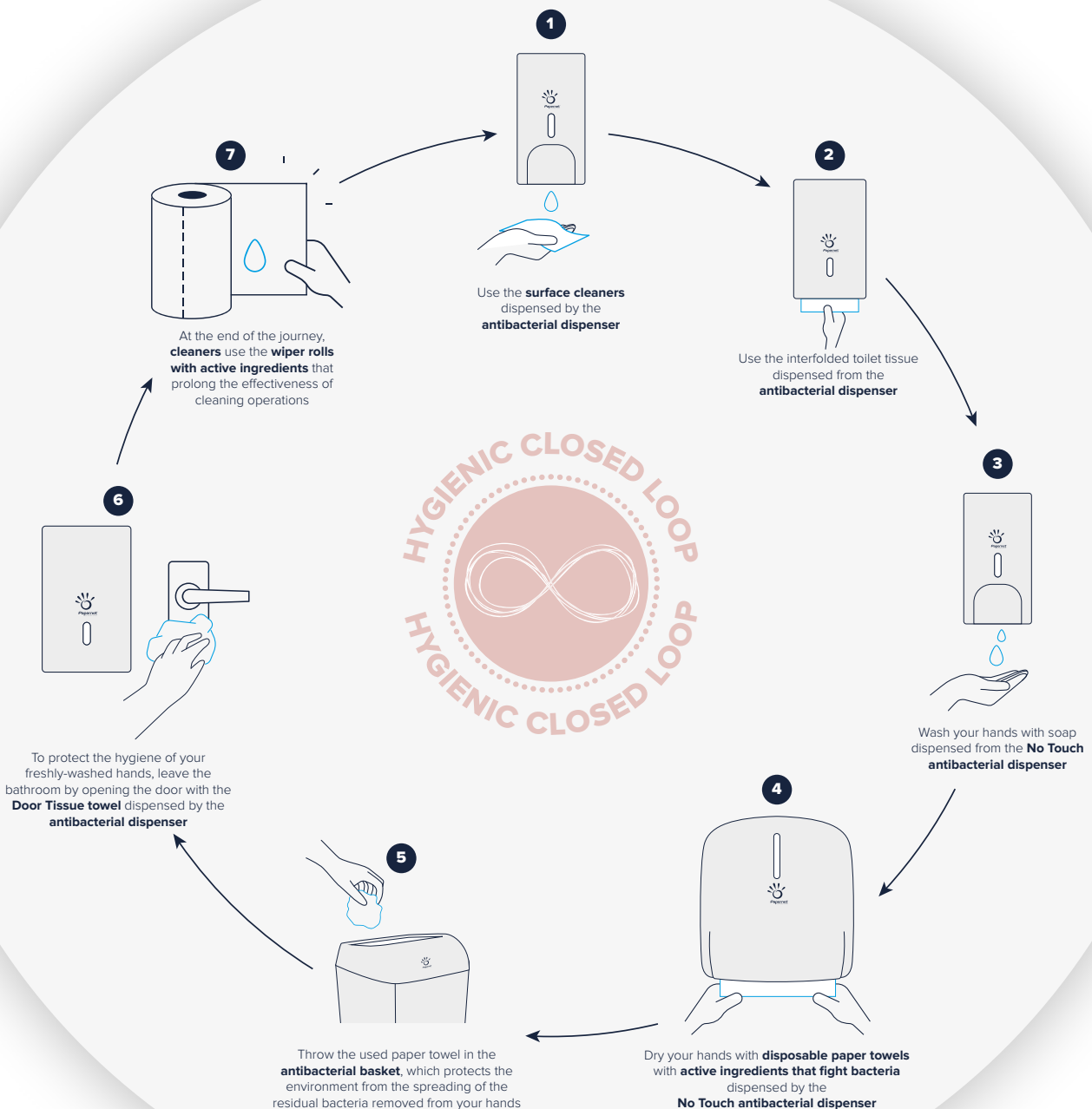

**HYGIENE,  
A CENTRAL TOPIC  
IN THE CREATION  
OF SHARED VALUE**

Hygiene is a primary asset that helps protect our health and the overall quality of our lives. Let's defend it together with conscious behaviours and choices.

# BE SMART HEALTHY BUSINESS

**1**

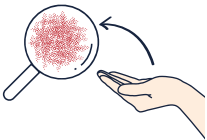

Hands are the main means of contact with the world and their proper hygiene is essential\*. Providing guests and operators with the right products, in the most sensitive areas, is an effective way to ensure maximum safety at every stage.

**2**

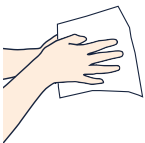

As demonstrated and supported by numerous studies and authoritative sources\*\*\*, paper towels are the best solution to reduce the proliferation of germs and bacteria on the hands and avoid their dispersion in the surrounding environment\*\*.

**3**

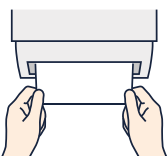

Papernet Antibacterial Towel Dispensers ensure the highest level of hygiene in the hand drying process, helping to significantly reduce bacteria in the environment.



\* The WHO claims that by just **washing our hands frequently with soap and water for about 30-40 seconds** can protect us from the thousands of germs and bacteria in the environment.

\*\*/\*\* Data source: <https://europeantissue.com/it/hygiene/studies/studio-universita-di-westminster-2008>

## HYGIENE A STRATEGIC VALUE

Hygiene is a priority in Health Care. Health regulations require companies to adhere to strict standards of cleanliness in all work areas. For this reason, Papernet is committed to offering suitable solutions to raise the level of hygiene and safety in all environments, providing, in the scheme below, a valid guide for the care of spaces.

## HEALTH CARE A SAFE JOURNEY FOR EVERY ENVIRONMENT

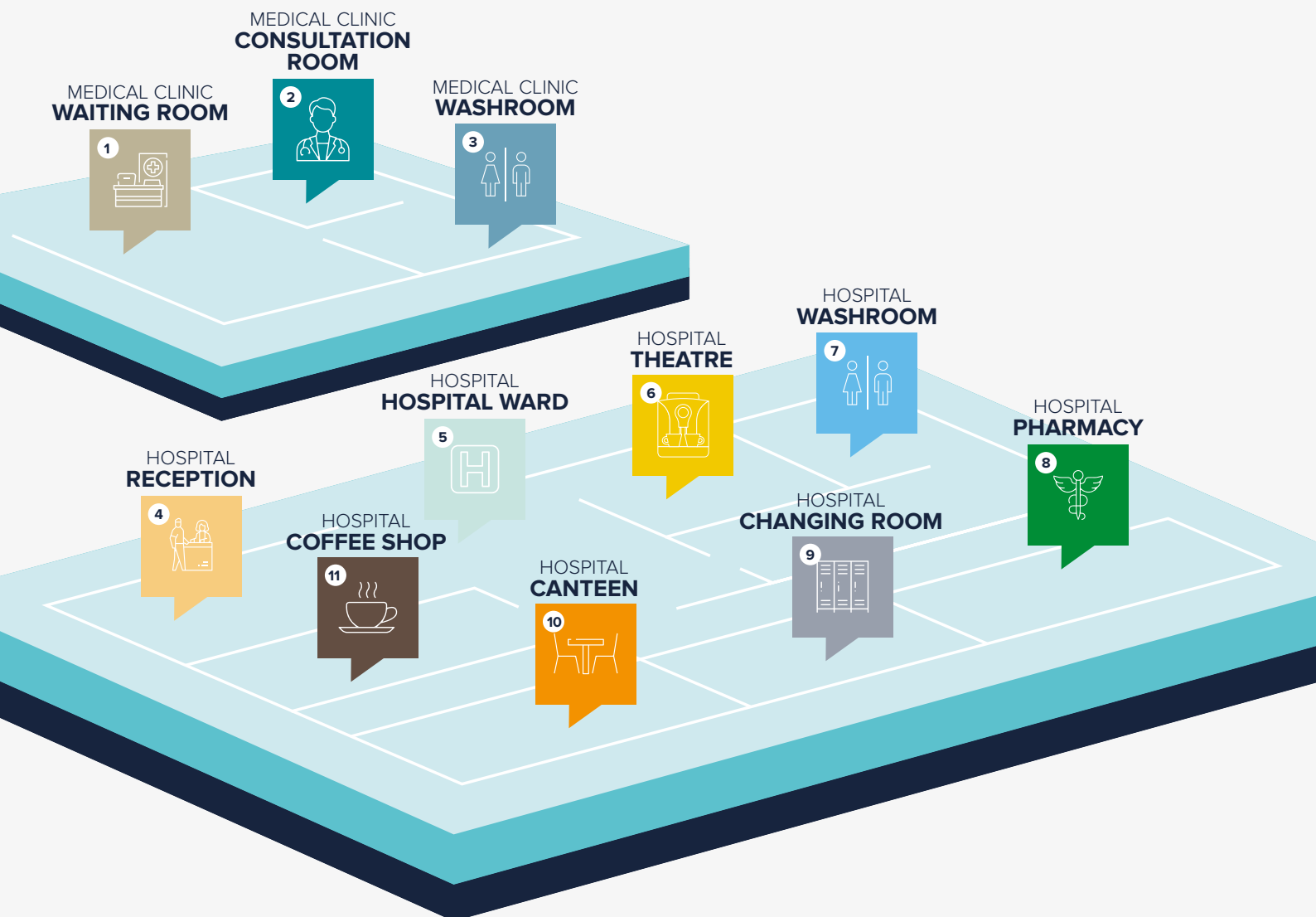



# MEDICAL CLINIC WAITING ROOM



**SURFACES WITH A HIGH PROBABILITY OF CONTAMINATION**

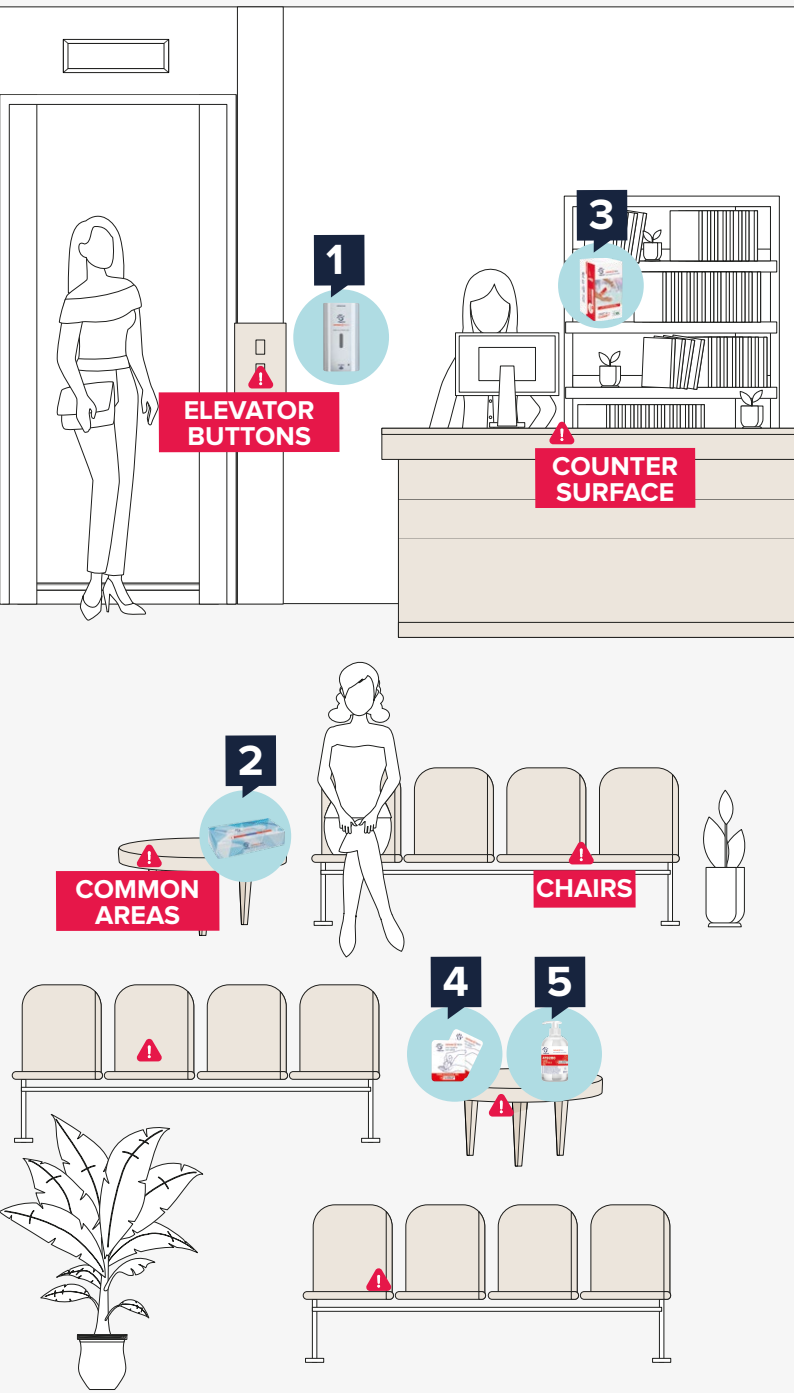

# HYGIENE SOLUTIONS

**1**

**NO TOUCH HAND ALCOHOLIC GEL DISPENSER**  
Code 419727



Thanks to **automatic dispensing**, the new **No Touch antibacterial dispenser** for hand alcoholic gel protects hand hygiene, reducing the risk of contamination.

**HAND ALCOHOLIC GEL**  
Code 417827

Sanitizing gel with **over 70% alcohol**, perfect to guarantee **hand hygiene**.

**2**

**FACIAL TISSUE**  
Code 415938



**UV treated tissues** that **inhibit bacteria and their proliferation** on the paper.

**3**

**WIPES "FAST & CLEAN"**  
Code 419295



Multi-purpose wipes for cleaning any surface and environment. A **practical and fast** solution which guarantees the **maximum level of protection and hygiene** thanks to the **antibacterial additive** present in the packaging.

**SURFACE CLEANER SPRAY**  
Code 419277

Spray cleaner ideal for all surfaces thanks to the action of the **active oxygen and alcohol**.

**4**

**HAND ALCOHOLIC GEL "MINI DEFEND"**  
Code 419284



Hand sanitizer gel with **over 70% alcohol** in a practical 1 ml **pocket size**, perfect to ensure **hand hygiene** always and everywhere.

**5**

**HAND ALCOHOLIC GEL**  
Code 419280



Sanitizing gel with **over 70% alcohol** in a 500 ml bottle with a practical dispenser, perfect to guarantee **hand hygiene**.



# MEDICAL CLINIC WAITING ROOM

**TAILORED  
SOLUTION**  
HYGIENE BEST PRACTICES



1

**419727**

## No Touch Hand Alcoholic Gel Dispenser



| Pieces per pack | Dispenser height | Dispenser length | Dispenser width | Capacity         | Dosage | Case dimensions | Case volume    | Cases per pallet |
|-----------------|------------------|------------------|-----------------|------------------|--------|-----------------|----------------|------------------|
| n°              | cm               | cm               | cm              | -                | ml     | cm              | m <sup>3</sup> | n°               |
| 1               | 25               | 12               | 13.5            | 0.50 lt - 1.2 lt | 1.1    | 14.5x26x13.8    | 0.005          | 216              |

Antibacterial

417827 - 419728



2

**417827**

## Hand Alcoholic Gel



| Capacity | Pack per case | Pack dimensions | Case dimensions | Case volume    | Cases per pallet |
|----------|---------------|-----------------|-----------------|----------------|------------------|
| ml       | n°            | cm              | cm              | m <sup>3</sup> | n°               |
| 500      | 12            | 8.8x11.7x8      | 35.9x13x24.2    | 0.011          | 63               |

Gel - Transparent

417829 - 419283 - 419727



3

**415938**

## Facial Tissue



| Ply | Sheets per piece | Sheet height | Sheet length | Case dimensions | Case volume    | Packs per case | Cases per pallet |
|-----|------------------|--------------|--------------|-----------------|----------------|----------------|------------------|
| n°  | n°               | cm           | cm           | cm              | m <sup>3</sup> | n°             | n°               |
| 2   | 100              | 20           | 21           | 40.3x24.7x60.3  | 0.060          | 40             | 36               |

Pure cellulose - White



**419277**

## Surface Cleaner Spray



| Capacity | Pack per case | Pack dimensions | Case dimensions | Case volume    | Cases per pallet |
|----------|---------------|-----------------|-----------------|----------------|------------------|
| ml       | n°            | cm              | cm              | m <sup>3</sup> | n°               |
| 750      | 6             | 9.5x25.5x6      | 17.5x29x26      | 0.013          | 72 (x2)          |

Detergent - Transparent

Compatible with the product 419295



**419295**

## Wipes "Fast & Clean"



| Ply | Sheets per piece | Sheet height | Sheet length | Folded dimensions | Case dimensions | Case volume    | Packs per case | Cases per pallet |
|-----|------------------|--------------|--------------|-------------------|-----------------|----------------|----------------|------------------|
| n°  | n°               | cm           | cm           | cm                | cm              | m <sup>3</sup> | n°             | n°               |
| 2   | 100              | 33.25        | 21.6         | 16.6x10.8         | 55x18.1x40.5    | 0.040          | 20             | 24 (x2)          |

Pure cellulose - White

Compatible with the product 419277





MEDICAL CLINIC  
**WAITING ROOM**



**4**

**419284**  
**Hand Alcoholic Gel**  
**"Mini Defend"**



| Capacity | Pieces per pack | Pack per case | Pack dimensions | Case dimensions | Case volume    | Cases per pallet |
|----------|-----------------|---------------|-----------------|-----------------|----------------|------------------|
| ml       | n°              | n°            | cm              | cm              | m <sup>3</sup> | n°               |
| 1        | 250             | 8             | 16x14x11.5      | 40x25x40        | 0.040          | 36               |

Gel - Transparent



**5**

**419280**  
**Hand Alcoholic Gel**



| Capacity | Pack per case | Pack dimensions | Case dimensions | Case volume    | Cases per pallet |
|----------|---------------|-----------------|-----------------|----------------|------------------|
| ml       | n°            | cm              | cm              | m <sup>3</sup> | n°               |
| 500      | 6             | 7x18x7          | 23.1x21x15.6    | 0.008          | 115 (x2)         |

Gel - Transparent







MEDICAL CLINIC  
**CONSULTATION ROOM**



**SURFACES WITH A HIGH PROBABILITY OF CONTAMINATION**

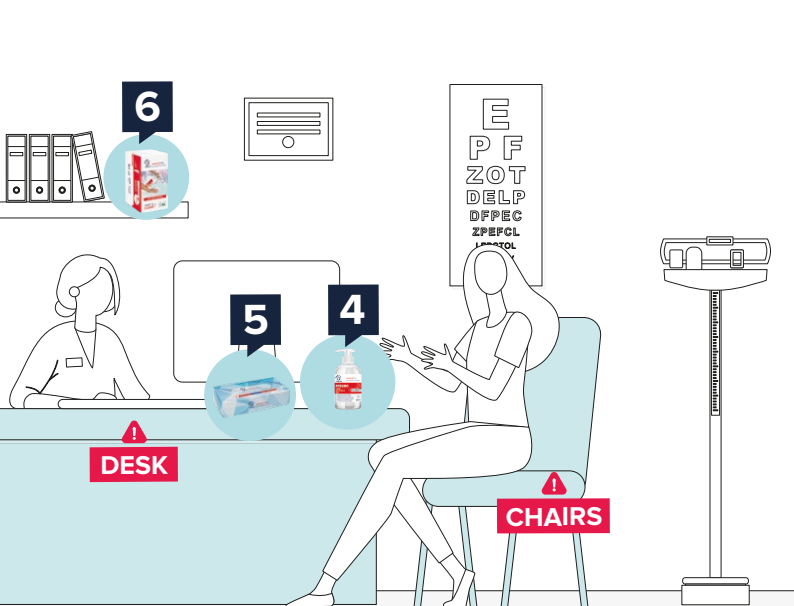
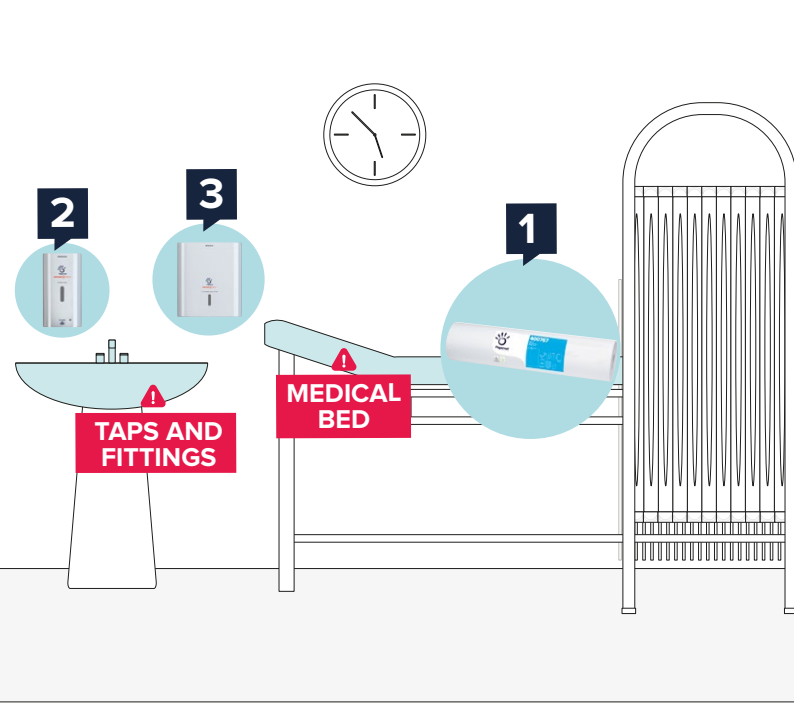

**HYGIENE SOLUTIONS**

**1**

**MEDICAL ROLL**  
Code 400767



Papernet's medical rolls are perfect to guarantee **maximum hygiene** in doctors' offices and hospitals. Their **special length** allows **reducing replacement times** to a minimum.

**2**

**NO TOUCH FOAM SOAP CARTRIDGE DISPENSER**  
Code 419720



Thanks to **automatic dispensing**, the new **No Touch antibacterial dispenser** for soap protects **hand hygiene**, reducing the risk of contamination.

**FOAM SOAP 0,5 LT**  
Code 411209

**FOAM SOAP 1,2 LT**  
Code 419723

Formulated to **reduce the bacterial load on hands** and **guarantee a deep sanitizing action**.

**3**

**C/V - FOLD HAND TOWEL DISPENSER**  
Code 416143



Allows a **practical and hygienic single amount** to be dispensed.

**V - FOLDED HAND TOWEL**  
Code 417820

Enriched with a special formula that **counteracts the bacterial load on the hands** during drying and **reduces the proliferation of bacteria in the environment**.

**4**

**HAND ALCOHOLIC GEL**  
Code 419280



Sanitizing gel with **over 70% alcohol** in a 500 ml bottle with a practical dispenser, perfect to guarantee hand hygiene.

**5**

**FACIAL TISSUE**  
Code 415938



**UV treated tissues** that inhibit bacteria and their proliferation on the paper.

**6**

**WIPES "FAST & CLEAN"**  
Code 419295

Multi-purpose wipes for cleaning any surface and environment. A **practical and fast** solution which guarantees the **maximum level of protection and hygiene** thanks to the **antibacterial additive** present in the packaging.



**SURFACE CLEANER SPRAY**  
Code 419277

Spray cleaner ideal for all surfaces thanks to the action of the **active oxygen and alcohol**.



# MEDICAL CLINIC CONSULTATION ROOM

**TAILORED  
SOLUTION**  
HYGIENE BEST PRACTICES



1

**400767**  
Medical Roll



| Ply | Sheets per piece | Roll length | Sheet height | Sheet length | Roll diameter | Core diameter | Pieces per pack | Case dimensions | Case volume | Packs per case | Cases per pallet |
|-----|------------------|-------------|--------------|--------------|---------------|---------------|-----------------|-----------------|-------------|----------------|------------------|
| n°  | n°               | mt          | cm           | cm           | cm            | cm            | n°              | cm              | m³          | n°             | n°               |
| 2   | 210              | 77          | 59.5         | 36.5         | 14.5          | 5.1           | 1               | 61x29.5x44      | 0.079       | 6              | 32               |

Pure cellulose - White



2

**419720**  
No Touch Foam Soap  
Cartridge Dispenser



| Pieces per pack | Dispenser height | Dispenser length | Dispenser width | Capacity         | Dosage | Case dimensions | Case volume | Cases per pallet |
|-----------------|------------------|------------------|-----------------|------------------|--------|-----------------|-------------|------------------|
| n°              | cm               | cm               | cm              | -                | ml     | cm              | m³          | n°               |
| 1               | 25               | 12               | 13.5            | 0.50 lt - 1.2 lt | 0.7    | 14.5x26x13.8    | 0.005       | 216              |

Antibacterial

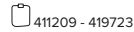

**411209**  
Foam Soap



| Capacity | Pack per case | Pack dimensions | Case dimensions | Case volume | Cases per pallet |
|----------|---------------|-----------------|-----------------|-------------|------------------|
| ml       | n°            | cm              | cm              | m³          | n°               |
| 500      | 12            | 8.8x11.7x8      | 35.9x13x24.2    | 0.011       | 63               |

Foam Soap - Transparent

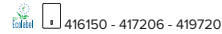

**419723**  
Foam Soap



| Capacity | Pack per case | Pack dimensions | Case dimensions | Case volume | Cases per pallet |
|----------|---------------|-----------------|-----------------|-------------|------------------|
| ml       | n°            | cm              | cm              | m³          | n°               |
| 1200     | 6             | 12x15.5x10      | 18x25x32.5      | 0.014       | 54 (x1)          |

Foam Soap - Transparent



3

**416143**  
C/V - Fold Hand Towel  
Dispenser



| Pieces per pack | Dispenser height | Dispenser length | Dispenser width | Capacity       | Case dimensions | Case volume | Cases per pallet |
|-----------------|------------------|------------------|-----------------|----------------|-----------------|-------------|------------------|
| n°              | cm               | cm               | cm              | -              | cm              | m³          | n°               |
| 1               | 33.6             | 30               | 14.5            | Max. 2.5 clips | 15.6x35.5x30.8  | 0.017       | 105              |

Antibacterial

Available also: ● Black 417204



**417820**  
V - Folded Hand Towel



| Ply | Sheets per piece | Sheet height | Sheet length | Folded dimensions | Case dimensions | Case volume | Packs per case | Cases per pallet |
|-----|------------------|--------------|--------------|-------------------|-----------------|-------------|----------------|------------------|
| n°  | n°               | cm           | cm           | cm                | cm              | m³          | n°             | n°               |
| 2   | 210              | 21           | 22           | 22x10.5           | 55x23x38.5      | 0.049       | 15             | 20 (x2)          |

Pure cellulose - White





# MEDICAL CLINIC CONSULTATION ROOM



4

## 419280 Hand Alcoholic Gel



| Capacity | Pack per case | Pack dimensions | Case dimensions | Case volume    | Cases per pallet |
|----------|---------------|-----------------|-----------------|----------------|------------------|
| ml       | n°            | cm              | cm              | m <sup>3</sup> | n°               |
| 500      | 6             | 7x18x7          | 23.1x21x15.6    | 0.008          | 115 (x2)         |

Gel - Transparent



5

## 415938 Facial Tissue



| Ply | Sheets per piece | Sheet height | Sheet length | Case dimensions | Case volume    | Packs per case | Cases per pallet |
|-----|------------------|--------------|--------------|-----------------|----------------|----------------|------------------|
| n°  | n°               | cm           | cm           | cm              | m <sup>3</sup> | n°             | n°               |
| 2   | 100              | 20           | 21           | 40.3x24.7x60.3  | 0.060          | 40             | 36               |

Pure cellulose - White



6

## 419277 Surface Cleaner Spray



| Capacity | Pack per case | Pack dimensions | Case dimensions | Case volume    | Cases per pallet |
|----------|---------------|-----------------|-----------------|----------------|------------------|
| ml       | n°            | cm              | cm              | m <sup>3</sup> | n°               |
| 750      | 6             | 9.5x25.5x6      | 17.5x29x26      | 0.013          | 72 (x2)          |

Detergent - Transparent

Compatible with the product 419295



## 419295 Wipes "Fast & Clean"



| Ply | Sheets per piece | Sheet height | Sheet length | Folded dimensions | Case dimensions | Case volume    | Packs per case | Cases per pallet |
|-----|------------------|--------------|--------------|-------------------|-----------------|----------------|----------------|------------------|
| n°  | n°               | cm           | cm           | cm                | cm              | m <sup>3</sup> | n°             | n°               |
| 2   | 100              | 33.25        | 21.6         | 16.6x10.8         | 55x18.1x40.5    | 0.040          | 20             | 24 (x2)          |

Pure cellulose - White

Compatible with the product 419277





MEDICAL CLINIC  
**WASHROOM**



**SURFACES WITH A HIGH PROBABILITY OF CONTAMINATION**

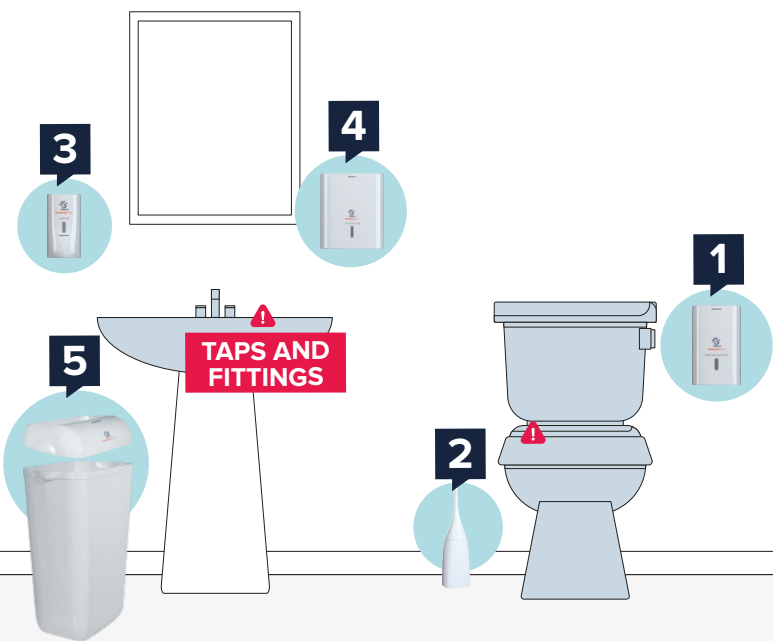

**1**

**TOILET TISSUE INTERFOLDED DISPENSER**  
Code 416147

Perfect for very small bathrooms with medium occupancy. **Optimizes waste** by dispensing one sheet at a time.



**TOILET TISSUE INTERFOLDED**  
Code 417818

New interfolded toilet tissue, **dispensed individually** and packed in an **antibacterial poly** to ensure the **maximum level of prevention**.

**2**

**WC BRUSH**  
Code 406628

For toilet cleaning and hygiene.



**3**

**LIQUID SOAP DISPENSER**  
Code 416151

The **antibacterial material**, present in the plastic and not only on the surface, makes it **completely safe** and helps **decrease the proliferation of germs and bacteria** in the environment.



**ANTIMICROBIAL SOAP 0,5 LT**  
Code 411210

Formulated to **reduce the bacterial load on hands** and **guarantee a deep sanitizing action**.

**4**

**C/V - FOLD HAND TOWEL DISPENSER**  
Code 416143

Allows a **practical and hygienic single amount** to be dispensed.



**V - FOLDED HAND TOWEL**  
Code 417820

Enriched with a special formula that **counteracts the bacterial load on the hands** during drying and **reduces the proliferation of bacteria in the environment**.

**5**

**LID AND BIN**  
Code 406629 - 406630

Waste bin with lid. Available in white and black.





# MEDICAL CLINIC WASHROOM

**TAILORED  
SOLUTION**  
HYGIENE BEST PRACTICES



1

**416147**

## Toilet Tissue Interfolded Dispenser



| Pieces per pack | Dispenser height | Dispenser length | Dispenser width | Capacity       | Case dimensions | Case volume    | Cases per pallet |
|-----------------|------------------|------------------|-----------------|----------------|-----------------|----------------|------------------|
| n°              | cm               | cm               | cm              | -              | cm              | m <sup>3</sup> | n°               |
| 1               | 26.5             | 16.5             | 13.5            | Max. 2.5 clips | 17.7x27.7x15.3  | 0.008          | 240              |

Antibacterial

Available also: ● Black 416157



**417818**

## Toilet Tissue Interfolded



| Ply | Sheets per piece | Sheet height | Sheet length | Folded dimensions | Pieces per pack | Case dimensions | Case volume    | Packs per case | Cases per pallet |
|-----|------------------|--------------|--------------|-------------------|-----------------|-----------------|----------------|----------------|------------------|
| n°  | n°               | cm           | cm           | cm                | n°              | cm              | m <sup>3</sup> | n°             | n°               |
| 2   | 200              | 21           | 11           | 11x10.5           | 6               | 60x34.5x44      | 0.091          | 12             | 12 (x2)          |

Pure cellulose - White

● □ 416147 - 416157 - 417812



2

**406628**

## WC Brush



| Pieces per pack | Dispenser height | Dispenser length | Dispenser width | Case dimensions | Case volume    | Cases per pallet |
|-----------------|------------------|------------------|-----------------|-----------------|----------------|------------------|
| n°              | cm               | cm               | cm              | cm              | m <sup>3</sup> | n°               |
| 4               | 48.5             | 12               | 12              | 24.5x24.5x49    | 0.029          | 48               |

Antibacterial



3

**416151**

## Liquid Soap Dispenser



| Pieces per pack | Dispenser height | Dispenser length | Dispenser width | Capacity | Dosage | Case dimensions | Case volume    | Cases per pallet |
|-----------------|------------------|------------------|-----------------|----------|--------|-----------------|----------------|------------------|
| n°              | cm               | cm               | cm              | -        | ml     | cm              | m <sup>3</sup> | n°               |
| 6               | 22               | 11.6             | 13.9            | 0.50 lt  | 1      | 39x25.5x33      | 0.033          | 54               |

Antibacterial

□ 411210



**411210**

## Antimicrobial Soap



| Capacity | Pack per case | Pack dimensions | Case dimensions | Case volume    | Cases per pallet |
|----------|---------------|-----------------|-----------------|----------------|------------------|
| ml       | n°            | cm              | cm              | m <sup>3</sup> | n°               |
| 500      | 12            | 8.8x11.7x8      | 35.9x13x24.2    | 0.011          | 63               |

Soap - Transparent

□ 416151 - 416158





## MEDICAL CLINIC WASHROOM

**TAILORED  
SOLUTION**  
HYGIENE BEST PRACTICES



4

**416143**

### C/V - Fold Hand Towel Dispenser



| Pieces per pack | Dispenser height | Dispenser length | Dispenser width | Capacity       | Case dimensions | Case volume    | Cases per pallet |
|-----------------|------------------|------------------|-----------------|----------------|-----------------|----------------|------------------|
| n°              | cm               | cm               | cm              | -              | cm              | m <sup>3</sup> | n°               |
| 1               | 33.6             | 30               | 14.5            | Max. 2.5 clips | 15.6x35.5x30.8  | 0.017          | 105              |

Antibacterial

Available also: ● Black 417204



**417820**

### V - Folded Hand Towel



| Ply | Sheets per piece | Sheet height | Sheet length | Folded dimensions | Case dimensions | Case volume    | Packs per case | Cases per pallet |
|-----|------------------|--------------|--------------|-------------------|-----------------|----------------|----------------|------------------|
| n°  | n°               | cm           | cm           | cm                | cm              | m <sup>3</sup> | n°             | n°               |
| 2   | 210              | 21           | 22           | 22x10.5           | 55x23x38.5      | 0.049          | 15             | 20 (x2)          |

Pure cellulose - White

●   416143 - 417204



5

**406630 + 406629**

### Lid and Bin



| Pieces per pack | Dispenser height | Dispenser length | Dispenser width | Capacity | Case dimensions | Case volume    | Cases per pallet |
|-----------------|------------------|------------------|-----------------|----------|-----------------|----------------|------------------|
| n°              | cm               | cm               | cm              | -        | cm              | m <sup>3</sup> | n°               |
| 6               | 9                | 34               | 23              | -        | 35x36.5x23.5    | 0.030          | 60               |
| 6               | 49               | 33               | 22              | 23 lt    | 44.5x72x34.5    | 0.111          | 15               |

Antibacterial

Available also: ● Black 417211 + 417210





## HOSPITAL RECEPTION



**SURFACES WITH A HIGH PROBABILITY OF CONTAMINATION**

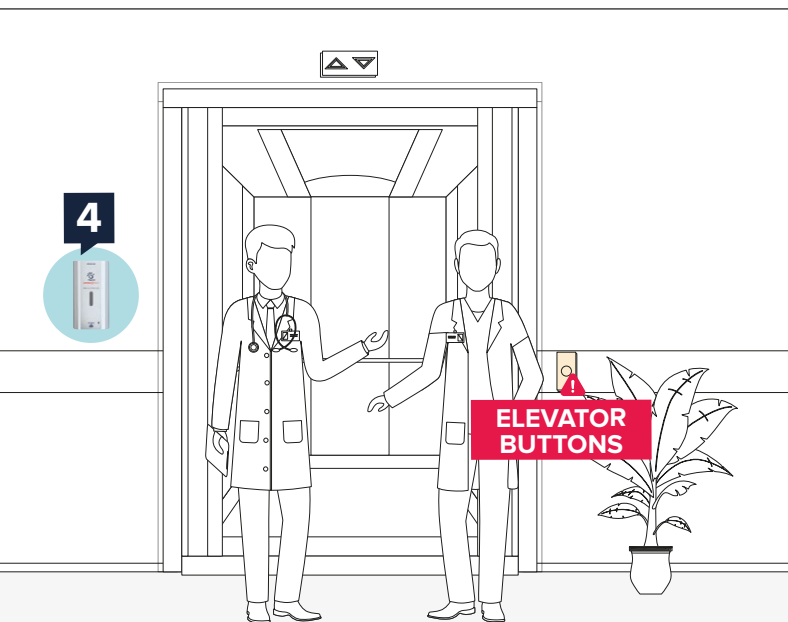
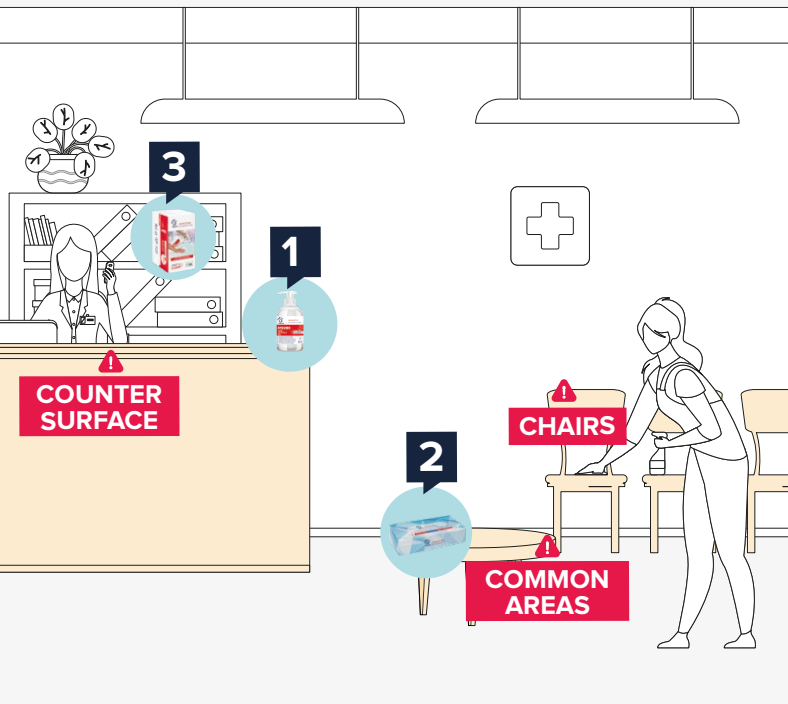

**1**

### HAND ALCOHOLIC GEL Code 419280

Sanitizing gel with **over 70% alcohol** in a 500 ml bottle with a practical dispenser, perfect to guarantee hand hygiene.



**2**

### FACIAL TISSUE Code 415938

**UV treated tissues** that **inhibit bacteria and their proliferation** on the paper.



**3**

### WIPES "FAST & CLEAN" Code 419295

Multi-purpose wipes for cleaning any surface and environment. A **practical and fast** solution which guarantees the **maximum level of protection and hygiene** thanks to the **antibacterial additive** present in the packaging.

### SURFACE CLEANER SPRAY Code 419277

Spray cleaner ideal for all surfaces thanks to the action of the **active oxygen and alcohol**.



**4**

### NO TOUCH HAND ALCOHOLIC GEL DISPENSER Code 419727

Thanks to **automatic dispensing**, the new **No Touch antibacterial dispenser** for hand alcoholic gel protects hand hygiene, reducing the risk of contamination.

### HAND ALCOHOLIC GEL Code 417827

Sanitizing gel with **over 70% alcohol**, perfect to guarantee **hand hygiene**.



# HOSPITAL RECEPTION

**TAILORED SOLUTION**  
HYGIENE BEST PRACTICES



1

**419280**

**Hand Alcoholic Gel**



| Capacity | Pack per case | Pack dimensions | Case dimensions | Case volume    | Cases per pallet |
|----------|---------------|-----------------|-----------------|----------------|------------------|
| ml       | n°            | cm              | cm              | m <sup>3</sup> | n°               |
| 500      | 6             | 7x18x7          | 23.1x21x15.6    | 0.008          | 115 (x2)         |

Gel - Transparent



2

**419338**

**Facial Tissue**



| Ply | Sheets per piece | Sheet height | Sheet length | Case dimensions | Case volume    | Packs per case | Cases per pallet |
|-----|------------------|--------------|--------------|-----------------|----------------|----------------|------------------|
| n°  | n°               | cm           | cm           | cm              | m <sup>3</sup> | n°             | n°               |
| 2   | 100              | 20           | 21           | 40.3x24.7x60.3  | 0.060          | 40             | 36               |

Pure cellulose - White



3

**419277**

**Surface Cleaner Spray**



| Capacity | Pack per case | Pack dimensions | Case dimensions | Case volume    | Cases per pallet |
|----------|---------------|-----------------|-----------------|----------------|------------------|
| ml       | n°            | cm              | cm              | m <sup>3</sup> | n°               |
| 750      | 6             | 9.5x25.5x6      | 17.5x29x26      | 0.013          | 72 (x2)          |

Detergent - Transparent

Compatible with the product 419295



**419295**

**Wipes "Fast & Clean"**



| Ply | Sheets per piece | Sheet height | Sheet length | Folded dimensions | Case dimensions | Case volume    | Packs per case | Cases per pallet |
|-----|------------------|--------------|--------------|-------------------|-----------------|----------------|----------------|------------------|
| n°  | n°               | cm           | cm           | cm                | cm              | m <sup>3</sup> | n°             | n°               |
| 2   | 100              | 33.25        | 21.6         | 16.6x10.8         | 55x18.1x40.5    | 0.040          | 20             | 24 (x2)          |

Pure cellulose - White

Compatible with the product 419277



4

**419727**

**No Touch Hand Alcoholic Gel Dispenser**



| Pieces per pack | Dispenser height | Dispenser length | Dispenser width | Capacity         | Dosage | Case dimensions | Case volume    | Cases per pallet |
|-----------------|------------------|------------------|-----------------|------------------|--------|-----------------|----------------|------------------|
| n°              | cm               | cm               | cm              | -                | ml     | cm              | m <sup>3</sup> | n°               |
| 1               | 25               | 12               | 13.5            | 0.50 lt - 1.2 lt | 1.1    | 14.5x26x13.8    | 0.005          | 216              |

Antibacterial

417827 - 419728



**417827**

**Hand Alcoholic Gel**



| Capacity | Pack per case | Pack dimensions | Case dimensions | Case volume    | Cases per pallet |
|----------|---------------|-----------------|-----------------|----------------|------------------|
| ml       | n°            | cm              | cm              | m <sup>3</sup> | n°               |
| 500      | 12            | 8.8x11.7x8      | 35.9x13x24.2    | 0.011          | 63               |

Gel - Transparent

417829 - 419283 - 419727







HOSPITAL  
**HOSPITAL WARD**



**SURFACES WITH A HIGH PROBABILITY OF CONTAMINATION**

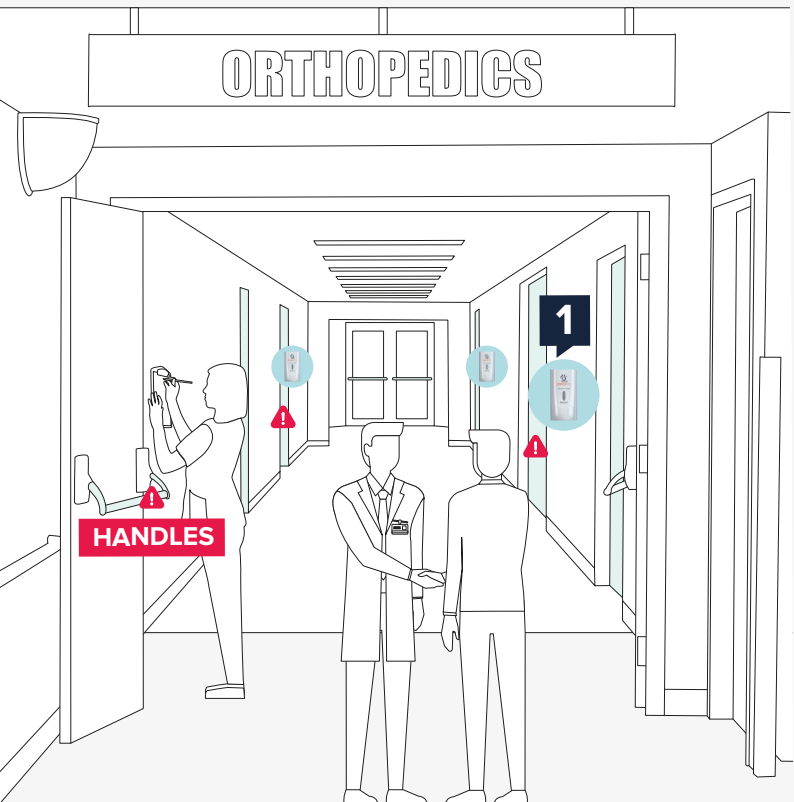
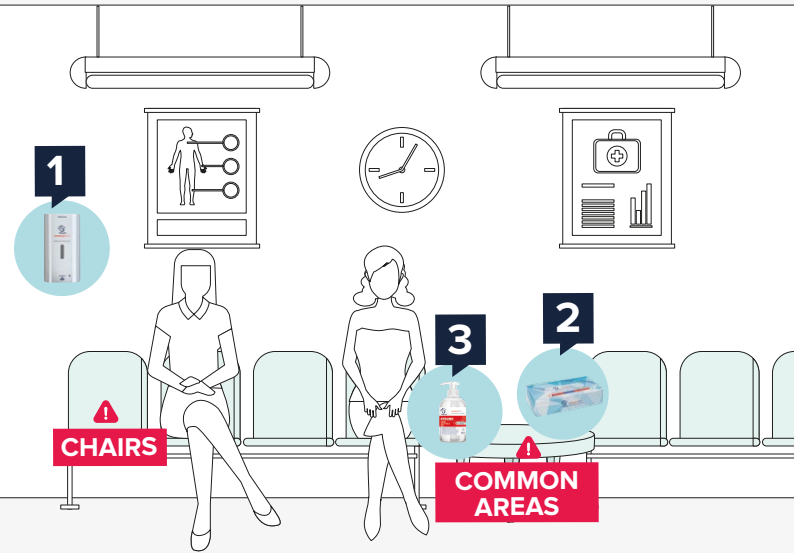

**HYGIENE SOLUTIONS**

**1**

**NO TOUCH HAND ALCOHOLIC GEL DISPENSER**  
Code 419727



Thanks to **automatic dispensing**, the new **No Touch antibacterial dispenser** for hand alcoholic gel protects hand hygiene, reducing the risk of contamination.

**HAND ALCOHOLIC GEL**  
Code 417827

Sanitizing gel with **over 70% alcohol**, perfect to guarantee **hand hygiene**.

**2**

**FACIAL TISSUE**  
Code 415938



**UV treated tissues** that **inhibit bacteria and their proliferation** on the paper.

**3**

**HAND ALCOHOLIC GEL**  
Code 419280



Sanitizing gel with **over 70% alcohol** in a 500 ml bottle with a practical dispenser, perfect to guarantee hand hygiene.



# HOSPITAL HOSPITAL WARD

**TAILORED  
SOLUTION**  
HYGIENE BEST PRACTICES



1

**419727**

## No Touch Hand Alcoholic Gel Dispenser



| Pieces per pack | Dispenser height | Dispenser length | Dispenser width | Capacity         | Dosage | Case dimensions | Case volume    | Cases per pallet |
|-----------------|------------------|------------------|-----------------|------------------|--------|-----------------|----------------|------------------|
| n°              | cm               | cm               | cm              | -                | ml     | cm              | m <sup>3</sup> | n°               |
| 1               | 25               | 12               | 13.5            | 0.50 lt - 1.2 lt | 1.1    | 14.5x26x13.8    | 0.005          | 216              |

Antibacterial  
417827 - 419728



**417827**

## Hand Alcoholic Gel



| Capacity | Pack per case | Pack dimensions | Case dimensions | Case volume    | Cases per pallet |
|----------|---------------|-----------------|-----------------|----------------|------------------|
| ml       | n°            | cm              | cm              | m <sup>3</sup> | n°               |
| 500      | 12            | 8.8x11.7x8      | 35.9x13x24.2    | 0.011          | 63               |

Gel - Transparent  
417829 - 419283 - 419727



2

**415938**

## Facial Tissue



| Ply | Sheets per piece | Sheet height | Sheet length | Case dimensions | Case volume    | Packs per case | Cases per pallet |
|-----|------------------|--------------|--------------|-----------------|----------------|----------------|------------------|
| n°  | n°               | cm           | cm           | cm              | m <sup>3</sup> | n°             | n°               |
| 2   | 100              | 20           | 21           | 40.3x24.7x60.3  | 0.060          | 40             | 36               |

Pure cellulose - White



3

**419280**

## Hand Alcoholic Gel



| Capacity | Pack per case | Pack dimensions | Case dimensions | Case volume    | Cases per pallet |
|----------|---------------|-----------------|-----------------|----------------|------------------|
| ml       | n°            | cm              | cm              | m <sup>3</sup> | n°               |
| 500      | 6             | 7x18x7          | 23.1x21x15.6    | 0.008          | 115 (x2)         |

Gel - Transparent





**HOSPITAL THEATRE**



**SURFACES WITH A HIGH PROBABILITY OF CONTAMINATION**

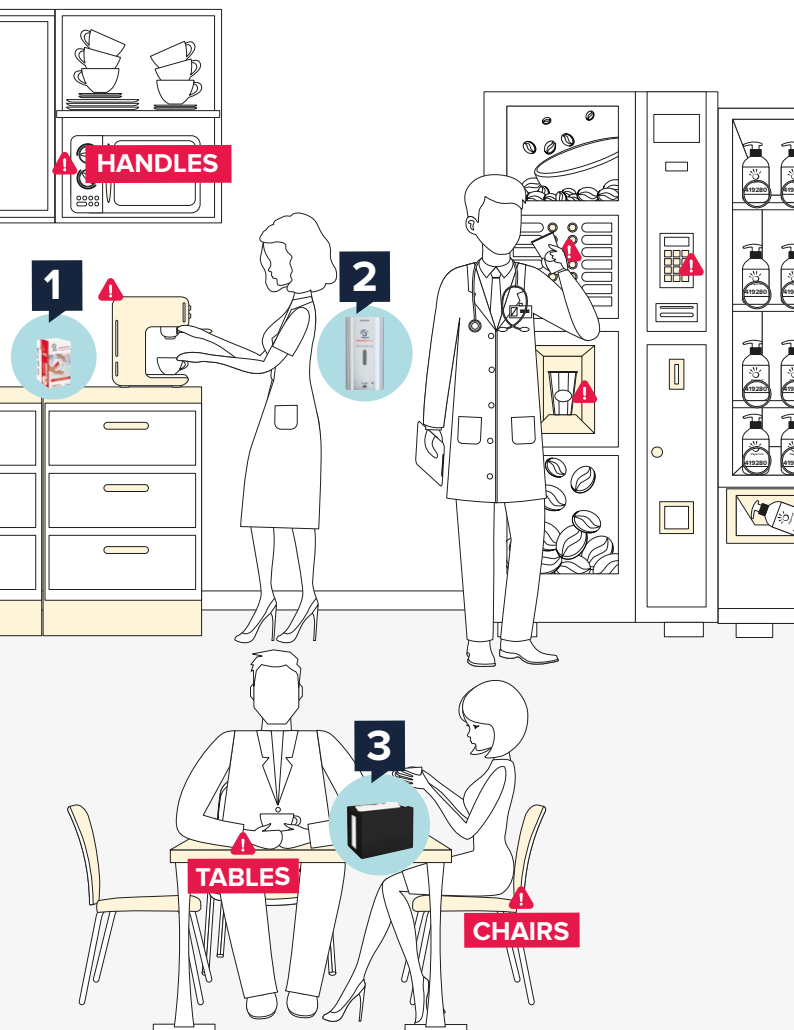

**HYGIENE SOLUTIONS**

**1**

**WIPES "FAST & CLEAN"**  
Code 419295

Multi-purpose wipes for cleaning any surface and environment. A **practical and fast** solution which guarantees the **maximum level of protection and hygiene** thanks to the **antibacterial additive** present in the packaging.



**SURFACE CLEANER SPRAY**  
Code 419277

Spray cleaner ideal for all surfaces thanks to the action of the **active oxygen and alcohol**.

**2**

**NO TOUCH HAND ALCOHOLIC GEL DISPENSER**  
Code 419727

Thanks to **automatic dispensing**, the new **No Touch antibacterial dispenser** for hand alcoholic gel protects hand hygiene, reducing the risk of contamination.



**HAND ALCOHOLIC GEL**  
Code 417827

Sanitizing gel with **over 70% alcohol**, perfect to guarantee **hand hygiene**.

**3**

**INTERFOLDED NAPKINS BASIC**  
Code 417811

The **antibacterial material**, present in the plastic and not only on the surface, makes it completely safe and helps **decrease the proliferation of germs and bacteria** in the environment.

Available colours



**HALF-FOLD NAPKINS INTERFOLDED**  
Code 416193

The **antibacterial additive** in the poly guarantees a greater **protection from external contamination agents** while the **easy opening** allows a single napkin to be taken.





HOSPITAL  
THEATRE

**TAILORED  
SOLUTION**  
HYGIENE BEST PRACTICES



1

**419277**  
Surface Cleaner  
Spray



| Capacity | Pack per case | Pack dimensions | Case dimensions | Case volume    | Cases per pallet |
|----------|---------------|-----------------|-----------------|----------------|------------------|
| ml       | n°            | cm              | cm              | m <sup>3</sup> | n°               |
| 750      | 6             | 9.5x25.5x6      | 17.5x29x26      | 0.013          | 72 (x2)          |

Detergent - Transparent

Compatible with the product 419295



**419295**  
Wipes "Fast & Clean"



| Ply | Sheets per piece | Sheet height | Sheet length | Folded dimensions | Case dimensions | Case volume    | Packs per case | Cases per pallet |
|-----|------------------|--------------|--------------|-------------------|-----------------|----------------|----------------|------------------|
| n°  | n°               | cm           | cm           | cm                | cm              | m <sup>2</sup> | n°             | n°               |
| 2   | 100              | 33.25        | 21.6         | 16.6x10.8         | 55x18.1x40.5    | 0.040          | 20             | 24 (x2)          |

Pure cellulose - White

Compatible with the product 419277



2

**419727**  
No Touch  
Hand Alcoholic Gel Dispenser



| Pieces per pack | Dispenser height | Dispenser length | Dispenser width | Capacity         | Dosage | Case dimensions | Case volume    | Cases per pallet |
|-----------------|------------------|------------------|-----------------|------------------|--------|-----------------|----------------|------------------|
| n°              | cm               | cm               | cm              | -                | ml     | cm              | m <sup>3</sup> | n°               |
| 1               | 25               | 12               | 13.5            | 0.50 lt - 1.2 lt | 1.1    | 14.5x26x13.8    | 0.005          | 216              |

Antibacterial

417827 - 419728



**417827**  
Hand Alcoholic Gel



| Capacity | Pack per case | Pack dimensions | Case dimensions | Case volume    | Cases per pallet |
|----------|---------------|-----------------|-----------------|----------------|------------------|
| ml       | n°            | cm              | cm              | m <sup>3</sup> | n°               |
| 500      | 12            | 8.8x11.7x8      | 35.9x13x24.2    | 0.011          | 63               |

Gel - Transparent

417829 - 419283 - 419727



3

**417811**  
Interfolded Napkins  
Dispenser Basic



| Pieces per pack | Dispenser height | Dispenser length | Dispenser width | Capacity    | Case dimensions | Case volume    | Cases per pallet |
|-----------------|------------------|------------------|-----------------|-------------|-----------------|----------------|------------------|
| n°              | cm               | cm               | cm              | -           | cm              | m <sup>3</sup> | n°               |
| 8               | 12.5             | 17.8             | 11.5            | Max. 1 clip | 37x26.5x25      | 0.025          | 63               |

Antibacterial

Available also:

Red Orange Lime White  
**417808** **417809** **417810** **417194**



**416193**  
Half-Fold Napkins  
Interfolded



| Ply | Sheets per piece | Sheet height | Sheet length | Folded dimensions | Pieces per pack | Case dimensions | Case volume    | Packs per case | Cases per pallet |
|-----|------------------|--------------|--------------|-------------------|-----------------|-----------------|----------------|----------------|------------------|
| n°  | n°               | cm           | cm           | cm                | n°              | cm              | m <sup>2</sup> | n°             | n°               |
| 1   | 330              | 21.6         | 16.6         | 16.6x10.8         | 1               | 34.8x55x40.5    | 0.078          | 40             | 12 (x2)          |

Pure cellulose - White

417192 - 417198 - 417199 - 417200 - 417201 - 417194 - 417808 - 417809 - 417810 - 417811



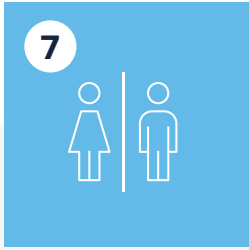

**HOSPITAL WASHROOM**



**SURFACES WITH A HIGH PROBABILITY OF CONTAMINATION**

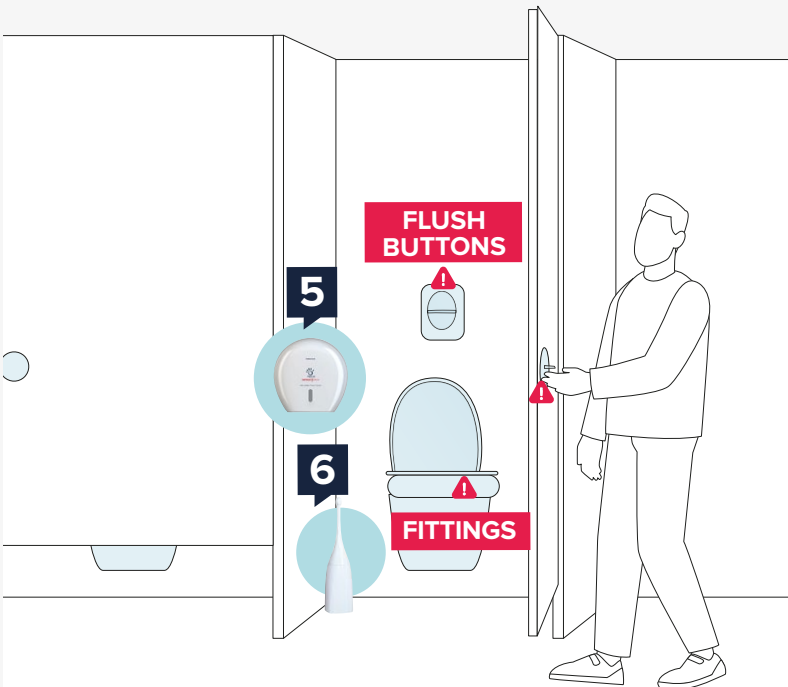

**HYGIENE SOLUTIONS**



**1**

**LIQUID SOAP DISPENSER**  
Code 416151

The **antibacterial material**, present in the plastic and not only on the surface, makes it **completely safe** and helps **decrease the proliferation of germs and bacteria** in the environment.

**ANTIMICROBIAL SOAP 0,5 LT**  
Code 411210

Formulated to **reduce the bacterial load on hands** and **guarantee a deep sanitizing action**.



**2**

**TOUCHLESS UNIVERSUS DISPENSER (NO ARMS)**  
Code 419274

The only dispenser **compatible with all wiper rolls**. Papernet confirms its ongoing commitment to research and innovation aimed at creating new cleaning solutions for every professional environment. Universus is the brand new dispenser ideally suited for high traffic areas such as public restrooms, commercial kitchens and canteens. **This new and exclusive design fits many types of wiper roll perfectly, keeping refills safe and hygienic.**

**HAND TOWEL ROLLS AUTOCUT**  
Code 416623

Autocut Dry Tech hand towels, with their **incredible length**, are perfect for all places that constantly need an effective and practical tool for **intense cleaning**.



**3**

**LID AND BIN**  
Code 406629 - 406630

Waste bin with lid. Available in white and black.



**4**

**DOOR TISSUE DISPENSER**  
Code 416173

The **antibacterial material**, present in the plastic and not only on the surface, makes it **completely safe** and **helps decrease the proliferation of germs and bacteria** in the environment.

**INTERFOLDED HAND TOWEL DOOR TISSUE**  
Code 417819

The paper is enriched with an **antibacterial formula** that protects the hands from contact with contaminated surfaces.



**5**

**TOILET TISSUE MINI JUMBO DISPENSER**  
Code 416145

The **antibacterial material**, present in the plastic and not only on the surface, makes it **completely safe** and **helps decrease the proliferation of germs and bacteria** in the environment.

**TOILET TISSUE MINI JUMBO**  
Code 416162

The Mini Jumbo Papernet toilet paper, thanks to its **considerable length**, it is ideal for all locations such as high turnout as it **reduces both the risk of exhaustion of the paper that the costs related to replacement of the roll**.



**6**

**WC BRUSH**  
Code 406628

For toilet cleaning and hygiene.



# HOSPITAL WASHROOM



1

## 416151 Liquid Soap Dispenser



| Pieces per pack | Dispenser height | Dispenser length | Dispenser width | Capacity | Dosage | Case dimensions | Case volume    | Cases per pallet |
|-----------------|------------------|------------------|-----------------|----------|--------|-----------------|----------------|------------------|
| n°              | cm               | cm               | cm              | -        | ml     | cm              | m <sup>3</sup> | n°               |
| 6               | 22               | 11.6             | 13.9            | 0.50 lt  | 1      | 39x25.5x33      | 0.033          | 54               |

Antibacterial



411210



## 411210 Antimicrobial Soap



| Capacity | Pack per case | Pack dimensions | Case dimensions | Case volume    | Cases per pallet |
|----------|---------------|-----------------|-----------------|----------------|------------------|
| ml       | n°            | cm              | cm              | m <sup>3</sup> | n°               |
| 500      | 12            | 8.8x11.7x8      | 35.9x13x24.2    | 0.011          | 63               |

Soap - Transparent



416151 - 416158



## 419274 Touchless Universus Dispenser (No Arms)



| Pieces per pack | Dispenser height | Dispenser length | Dispenser width | Capacity            | Case dimensions | Case volume    | Cases per pallet |
|-----------------|------------------|------------------|-----------------|---------------------|-----------------|----------------|------------------|
| n°              | cm               | cm               | cm              | -                   | cm              | m <sup>3</sup> | n°               |
| 1               | 33.3             | 32.1             | 22.6            | Max. Ø cm 20 x 22 h | 36x34x25.3      | 0.030          | 48               |

Antibacterial



## 416623 Hand Towel Rolls Autocut



| Ply | Sheets per piece | Roll length | Sheet height | Sheet length | Roll diameter | Core diameter | Pieces per pack | Case dimensions | Case volume    | Packs per case | Cases per pallet |
|-----|------------------|-------------|--------------|--------------|---------------|---------------|-----------------|-----------------|----------------|----------------|------------------|
| n°  | n°               | mt          | cm           | cm           | cm            | cm            | n°              | cm              | m <sup>3</sup> | n°             | n°               |
| 2   | 1                | 100         | 21           | 10000        | 18.5          | 4             | 6               | 21x37x55.5      | 0.043          | 1              | 44               |

Pure cellulose - White



416153 - 416155 - 417209



## 406630 + 406629 Lid and Bin



| Pieces per pack | Dispenser height | Dispenser length | Dispenser width | Capacity | Case dimensions | Case volume    | Cases per pallet |
|-----------------|------------------|------------------|-----------------|----------|-----------------|----------------|------------------|
| n°              | cm               | cm               | cm              | -        | cm              | m <sup>3</sup> | n°               |
| 6               | 9                | 34               | 23              | -        | 35x36.5x23.5    | 0.030          | 60               |
| 6               | 49               | 33               | 22              | 23 lt    | 44.5x72x34.5    | 0.111          | 15               |

Antibacterial

Available also: ● Black 417211 + 417210



## 416173 Door Tissue Dispenser



| Pieces per pack | Dispenser height | Dispenser length | Dispenser width | Capacity       | Case dimensions | Case volume    | Cases per pallet |
|-----------------|------------------|------------------|-----------------|----------------|-----------------|----------------|------------------|
| n°              | cm               | cm               | cm              | -              | cm              | m <sup>3</sup> | n°               |
| 1               | 26.5             | 16.5             | 13.5            | Max. 2.5 clips | 17.7x27.7x15.3  | 0.008          | 240              |

Antibacterial

Available also: ● Black 419286



## 417819 Interfolded Hand Towel Door Tissue



| Ply | Sheets per piece | Sheet height | Sheet length | Folded dimensions | Pieces per pack | Case dimensions | Case volume    | Packs per case | Cases per pallet |
|-----|------------------|--------------|--------------|-------------------|-----------------|-----------------|----------------|----------------|------------------|
| n°  | n°               | cm           | cm           | cm                | n°              | cm              | m <sup>3</sup> | n°             | n°               |
| 2   | 200              | 21           | 11           | 11x10.5           | 6               | 60x34.5x44      | 0.091          | 12             | 12 (x2)          |

Pure cellulose - White



416173 - 419286





# HOSPITAL WASHROOM

**TAILORED  
SOLUTION**  
HYGIENE BEST PRACTICES



5

**416145**

## Toilet Tissue Mini Jumbo Dispenser



| Pieces per pack | Dispenser height | Dispenser length | Dispenser width | Capacity           | Case dimensions | Case volume    | Cases per pallet |
|-----------------|------------------|------------------|-----------------|--------------------|-----------------|----------------|------------------|
| n°              | cm               | cm               | cm              | -                  | cm              | m <sup>3</sup> | n°               |
| 1               | 24.9             | 25.7             | 14.8            | Max Ø cm 23 x 10 h | 16x26.2x27.6    | 0.011          | 140              |

Antibacterial

Available also: ● Black 416160



**416162**

## Toilet Tissue Mini Jumbo



| Ply | Sheets per piece | Roll length | Sheet height | Sheet length | Roll diameter | Core diameter | Pieces per pack | Case dimensions | Case volume    | Packs per case | Cases per pallet |
|-----|------------------|-------------|--------------|--------------|---------------|---------------|-----------------|-----------------|----------------|----------------|------------------|
| n°  | n°               | mt          | cm           | cm           | cm            | cm            | n°              | cm              | m <sup>3</sup> | n°             | n°               |
| 1   | 1                | 300         | 8.9          | 30000        | 20            | 6             | 12              | 17.8x40x60      | 0.043          | 1              | 52               |

Pure cellulose - White

416160 - 416145



6

**406628**

## WC Brush



| Pieces per pack | Dispenser height | Dispenser length | Dispenser width | Case dimensions | Case volume    | Cases per pallet |
|-----------------|------------------|------------------|-----------------|-----------------|----------------|------------------|
| n°              | cm               | cm               | cm              | cm              | m <sup>3</sup> | n°               |
| 4               | 48.5             | 12               | 12              | 24.5x24.5x49    | 0.029          | 48               |

Antibacterial





HOSPITAL  
**PHARMACY**



**SURFACES WITH  
A HIGH PROBABILITY  
OF CONTAMINATION**

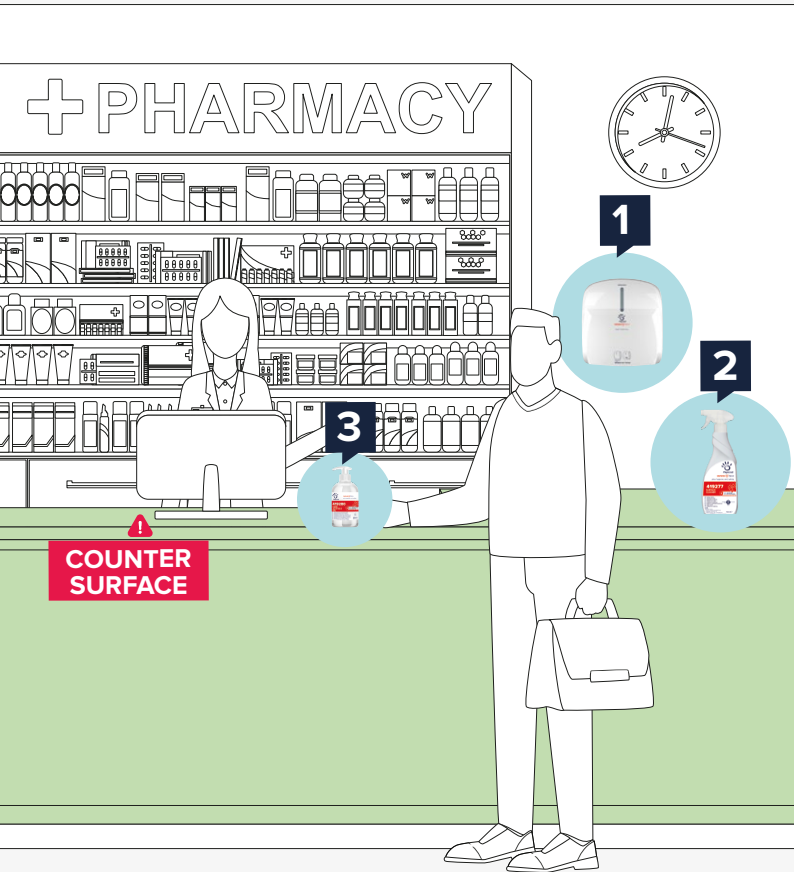

**HYGIENE SOLUTIONS**

**1**

**ELECTRONIC MINI AUTOCUT DISPENSER**

**Code 416153**

Thanks to automatic dispensing, the **No Touch Autocut** antibacterial dispenser **protects hand hygiene**, reducing the risk of contamination.



**HAND TOWEL ROLLS AUTOCUT**

**Code 407558**

Autocut Dry Tech hand towels, with their **incredible length**, are perfect for all places that constantly need an effective and practical tool for **intense cleaning**.



**2**

**SURFACE CLEANER SPRAY**

**Code 419277**

Spray cleaner ideal for all surfaces thanks to the action of the **active oxygen and alcohol**.



**3**

**HAND ALCOHOLIC GEL**

**Code 419280**

Sanitizing gel with **over 70% alcohol** in a 500 ml bottle with a practical dispenser, perfect to guarantee hand hygiene.







HOSPITAL  
PHARMACY

**TAILORED  
SOLUTION**  
HYGIENE BEST PRACTICES



1

**416153**

**Electronic Mini Autocut  
Dispenser**



| Pieces per pack | Dispenser height | Dispenser length | Dispenser width | Capacity            | Case dimensions | Case volume    | Cases per pallet |
|-----------------|------------------|------------------|-----------------|---------------------|-----------------|----------------|------------------|
| n°              | cm               | cm               | cm              | -                   | cm              | m <sup>3</sup> | n°               |
| 1               | 37.1             | 33               | 22.1            | Max. ø cm 20 x 21 h | 34x38.5x23      | 0.033          | 50               |

Antibacterial



**407558**

**Hand Towel Rolls  
Autocut**



| Ply | Sheets per piece | Roll length | Sheet height | Sheet length | Roll diameter | Core diameter | Pieces per pack | Case dimensions | Case volume    | Packs per case | Cases per pallet |
|-----|------------------|-------------|--------------|--------------|---------------|---------------|-----------------|-----------------|----------------|----------------|------------------|
| n°  | n°               | mt          | cm           | cm           | cm            | cm            | n°              | cm              | m <sup>3</sup> | n°             | n°               |
| 2   | 1                | 100         | 20           | 10000        | 18.5          | 4             | 6               | 20x37x55.5      | 0.041          | 1              | 44               |

Pure cellulose - White

416153 - 416155 - 417209



2

**419277**

**Surface Cleaner  
Spray**



| Capacity | Pack per case | Pack dimensions | Case dimensions | Case volume    | Cases per pallet |
|----------|---------------|-----------------|-----------------|----------------|------------------|
| ml       | n°            | cm              | cm              | m <sup>3</sup> | n°               |
| 750      | 6             | 9.5x25.5x6      | 17.5x29x26      | 0.013          | 72 (x2)          |

Detergent - Transparent

Compatible with the product 419295



3

**419280**

**Hand Alcoholic Gel**



| Capacity | Pack per case | Pack dimensions | Case dimensions | Case volume    | Cases per pallet |
|----------|---------------|-----------------|-----------------|----------------|------------------|
| ml       | n°            | cm              | cm              | m <sup>3</sup> | n°               |
| 500      | 6             | 7x18x7          | 23.1x21x15.6    | 0.008          | 115 (x2)         |

Gel - Transparent





# HOSPITAL CHANGING ROOM



**SURFACES WITH A HIGH PROBABILITY OF CONTAMINATION**

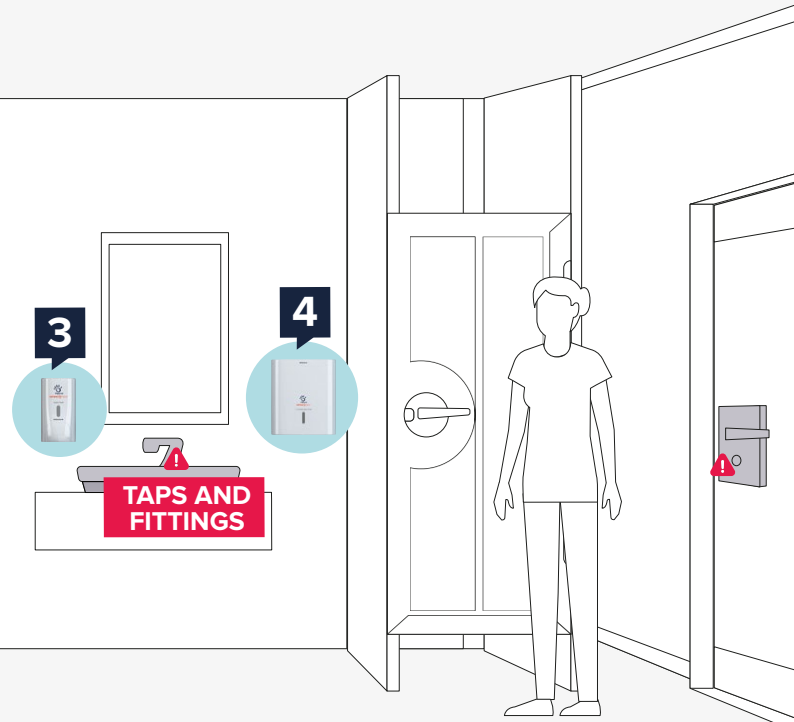
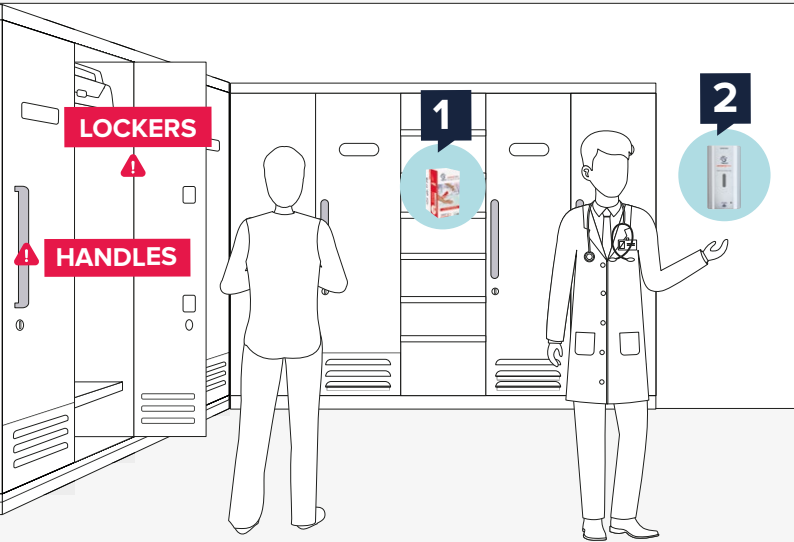

**1**

**WIPES "FAST & CLEAN"**  
Code 419295

Multi-purpose wipes for cleaning any surface and environment. A **practical and fast** solution which guarantees the **maximum level of protection and hygiene** thanks to the **antibacterial additive** present in the packaging.



**SURFACE CLEANER SPRAY**  
Code 419277

Spray cleaner ideal for all surfaces thanks to the action of the **active oxygen and alcohol**.

**2**

**NO TOUCH HAND ALCOHOLIC GEL DISPENSER**  
Code 419727

Thanks to **automatic dispensing**, the new **No Touch antibacterial dispenser** for hand alcoholic gel protects hand hygiene, reducing the risk of contamination.



**HAND ALCOHOLIC GEL**  
Code 417827

Sanitizing gel with **over 70% alcohol**, perfect to guarantee **hand hygiene**.

**3**

**LIQUID SOAP DISPENSER**  
Code 416151

The **antibacterial material**, present in the plastic and not only on the surface, makes it **completely safe** and helps **decrease the proliferation of germs and bacteria** in the environment.



**ANTIMICROBIAL SOAP 0,5 LT**  
Code 411210

Formulated to **reduce the bacterial load on hands** and **guarantee a deep sanitizing action**.

**4**

**C/V - FOLD HAND TOWEL DISPENSER**  
Code 416143

Allows a **practical and hygienic single amount** to be dispensed.



**V - FOLDED HAND TOWEL**  
Code 417820

Enriched with a special formula that **counteracts the bacterial load on the hands** during drying and **reduces the proliferation of bacteria in the environment**.



# HOSPITAL CHANGING ROOM

**TAILORED  
SOLUTION**  
HYGIENE BEST PRACTICES



1

**419277**

## Surface Cleaner Spray



| Capacity | Pack per case | Pack dimensions | Case dimensions | Case volume    | Cases per pallet |
|----------|---------------|-----------------|-----------------|----------------|------------------|
| ml       | n°            | cm              | cm              | m <sup>3</sup> | n°               |
| 750      | 6             | 9.5x25.5x6      | 17.5x29x26      | 0.013          | 72 (x2)          |

Detergent - Transparent

Compatible with the product 419295

**DEFEND+TECH**

**419295**

## Wipes "Fast & Clean"



| Ply | Sheets per piece | Sheet height | Sheet length | Folded dimensions | Case dimensions | Case volume    | Packs per case | Cases per pallet |
|-----|------------------|--------------|--------------|-------------------|-----------------|----------------|----------------|------------------|
| n°  | n°               | cm           | cm           | cm                | cm              | m <sup>3</sup> | n°             | n°               |
| 2   | 100              | 33.25        | 21.6         | 16.6x10.8         | 55x18.1x40.5    | 0.040          | 20             | 24 (x2)          |

Pure cellulose - White

Compatible with the product 419277

**DEFEND+TECH**

2

**419727**

## No Touch Hand Alcoholic Gel Dispenser



| Pieces per pack | Dispenser height | Dispenser length | Dispenser width | Capacity         | Dosage | Case dimensions | Case volume    | Cases per pallet |
|-----------------|------------------|------------------|-----------------|------------------|--------|-----------------|----------------|------------------|
| n°              | cm               | cm               | cm              | -                | ml     | cm              | m <sup>3</sup> | n°               |
| 1               | 25               | 12               | 13.5            | 0.50 lt - 1.2 lt | 1.1    | 14.5x26x13.8    | 0.005          | 216              |

Antibacterial

417827 - 419728

**DEFEND+TECH**

**417827**

## Hand Alcoholic Gel



| Capacity | Pack per case | Pack dimensions | Case dimensions | Case volume    | Cases per pallet |
|----------|---------------|-----------------|-----------------|----------------|------------------|
| ml       | n°            | cm              | cm              | m <sup>3</sup> | n°               |
| 500      | 12            | 8.8x11.7x8      | 35.9x13x24.2    | 0.011          | 63               |

Gel - Transparent

417829 - 419283 - 419727

**DEFEND+TECH**

3

**416151**

## Liquid Soap Dispenser



| Pieces per pack | Dispenser height | Dispenser length | Dispenser width | Capacity | Dosage | Case dimensions | Case volume    | Cases per pallet |
|-----------------|------------------|------------------|-----------------|----------|--------|-----------------|----------------|------------------|
| n°              | cm               | cm               | cm              | -        | ml     | cm              | m <sup>3</sup> | n°               |
| 6               | 22               | 11.6             | 13.9            | 0.50 lt  | 1      | 39x25.5x33      | 0.033          | 54               |

Antibacterial

411210

**DEFEND+TECH**

**411210**

## Antimicrobial Soap



| Capacity | Pack per case | Pack dimensions | Case dimensions | Case volume    | Cases per pallet |
|----------|---------------|-----------------|-----------------|----------------|------------------|
| ml       | n°            | cm              | cm              | m <sup>3</sup> | n°               |
| 500      | 12            | 8.8x11.7x8      | 35.9x13x24.2    | 0.011          | 63               |

Soap - Transparent

416151 - 416158

**DEFEND+TECH**



## HOSPITAL CHANGING ROOM

**TAILORED  
SOLUTION**  
HYGIENE BEST PRACTICES



4

**416143**

### C/V - Fold Hand Towel Dispenser



| Pieces per pack | Dispenser height | Dispenser length | Dispenser width | Capacity       | Case dimensions | Case volume    | Cases per pallet |
|-----------------|------------------|------------------|-----------------|----------------|-----------------|----------------|------------------|
| n°              | cm               | cm               | cm              | -              | cm              | m <sup>3</sup> | n°               |
| 1               | 33.6             | 30               | 14.5            | Max. 2.5 clips | 15.6x35.5x30.8  | 0.017          | 105              |

Antibacterial  
Available also: ● Black 417204



**417820**

### V - Folded Hand Towel



| Ply | Sheets per piece | Sheet height | Sheet length | Folded dimensions | Case dimensions | Case volume    | Packs per case | Cases per pallet |
|-----|------------------|--------------|--------------|-------------------|-----------------|----------------|----------------|------------------|
| n°  | n°               | cm           | cm           | cm                | cm              | m <sup>3</sup> | n°             | n°               |
| 2   | 210              | 21           | 22           | 22x10.5           | 55x23x38.5      | 0.049          | 15             | 20 (x2)          |

Pure cellulose - White  
 416143 - 417204



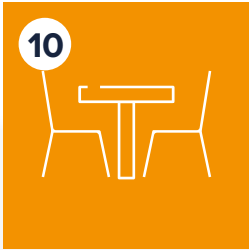

HOSPITAL  
**CANTEEN**  
DINING AREA



**SURFACES WITH  
A HIGH PROBABILITY  
OF CONTAMINATION**

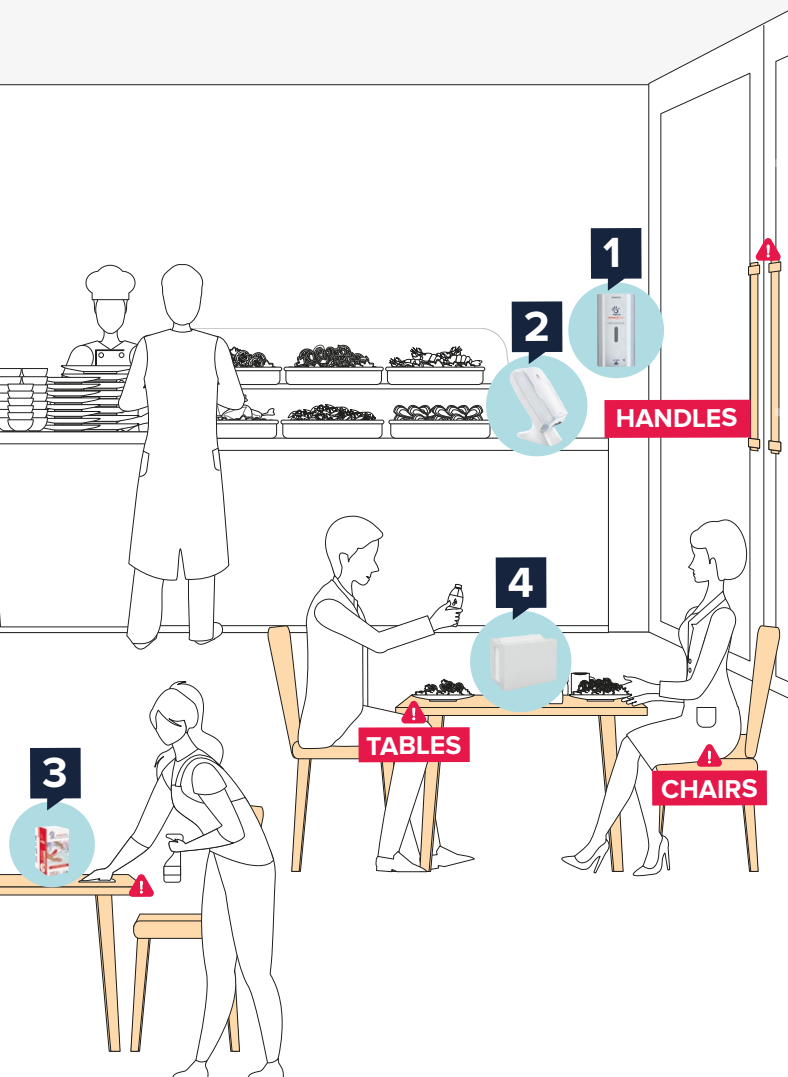

# HYGIENE SOLUTIONS

**1**

**NO TOUCH HAND ALCOHOLIC GEL DISPENSER**  
Code 419727



Thanks to **automatic dispensing**, the new **No Touch antibacterial dispenser** for hand alcoholic gel protects hand hygiene, reducing the risk of contamination.

**HAND ALCOHOLIC GEL**  
Code 417827

Sanitizing gel with **over 70% alcohol**, perfect to guarantee **hand hygiene**.

**2**

**INTERFOLDED NAPKINS DISPENSER**  
Code 416169



The Papernet dispenser for interfolded napkins allows a **rationed use of napkins**, through the **delivery of one sheet at a time**, favoring the **saving** and **reducing waste**.

**HALF-FOLD NAPKINS INTERFOLDED**  
Code 416193



The **antibacterial additive** in the poly guarantees a greater **protection from external contamination agents** while the **easy opening** allows a single napkin to be taken.

**3**

**WIPES "FAST & CLEAN"**  
Code 419295



Multi-purpose wipes for cleaning any surface and environment. A **practical and fast** solution which guarantees the **maximum level of protection and hygiene** thanks to the **antibacterial additive** present in the packaging.

**SURFACE CLEANER SPRAY**  
Code 419277

Spray cleaner ideal for all surfaces thanks to the action of the **active oxygen and alcohol**.

**4**

**INTERFOLDED NAPKINS DISPENSER BASIC**  
Code 417194



The **antibacterial material**, present in the plastic and not only on the surface, makes it completely safe and helps **decrease the proliferation of germs and bacteria** in the environment.

Available colours



**QUARTER-FOLD NAPKINS INTERFOLDED**  
Code 416182



The **antibacterial additive** in the poly guarantees a greater **protection from external contamination agents** while the **easy opening** allows a single napkin to be taken.



HOSPITAL  
**CANTEEN**  
DINING AREA

**TAILORED SOLUTION**  
HYGIENE BEST PRACTICES



1

**419727**

**No Touch Hand Alcoholic Gel Dispenser**



| Pieces per pack | Dispenser height | Dispenser length | Dispenser width | Capacity         | Dosage | Case dimensions | Case volume | Cases per pallet |
|-----------------|------------------|------------------|-----------------|------------------|--------|-----------------|-------------|------------------|
| n°              | cm               | cm               | cm              | -                | ml     | cm              | m³          | n°               |
| 1               | 25               | 12               | 13.5            | 0.50 lt - 1.2 lt | 1.1    | 14.5x26x13.8    | 0.005       | 216              |

Antibacterial

417827 - 419728



**417827**

**Hand Alcoholic Gel**



| Capacity | Pack per case | Pack dimensions | Case dimensions | Case volume | Cases per pallet |
|----------|---------------|-----------------|-----------------|-------------|------------------|
| ml       | n°            | cm              | cm              | m³          | n°               |
| 500      | 12            | 8.8x11.7x8      | 35.9x13x24.2    | 0.011       | 63               |

Gel - Transparent

417829 - 419283 - 419727



2

**416169**

**Interfolded Napkins Dispenser**



| Pieces per pack | Dispenser height | Dispenser length | Dispenser width | Capacity     | Case dimensions | Case volume | Cases per pallet |
|-----------------|------------------|------------------|-----------------|--------------|-----------------|-------------|------------------|
| n°              | cm               | cm               | cm              | -            | cm              | m³          | n°               |
| 1               | 46.1             | 22.5             | 34.7            | Max. 3 clips | 36.5x48.5x24    | 0.042       | 36               |

Antibacterial



**416193**

**Half-Fold Napkins Interfolded**



| Ply | Sheets per piece | Sheet height | Sheet length | Folded dimensions | Pieces per pack | Case dimensions | Case volume | Packs per case | Cases per pallet |
|-----|------------------|--------------|--------------|-------------------|-----------------|-----------------|-------------|----------------|------------------|
| n°  | n°               | cm           | cm           | cm                | n°              | cm              | m³          | n°             | n°               |
| 1   | 330              | 21.6         | 16.6         | 16.6x10.8         | 1               | 34.8x55x40.5    | 0.078       | 40             | 12 (x2)          |

Pure cellulose - White

417192 - 417198 - 417199 - 417200 - 417201 - 417194 - 417808 - 417809 - 417810 - 417811



3

**419277**

**Surface Cleaner Spray**



| Capacity | Pack per case | Pack dimensions | Case dimensions | Case volume | Cases per pallet |
|----------|---------------|-----------------|-----------------|-------------|------------------|
| ml       | n°            | cm              | cm              | m³          | n°               |
| 750      | 6             | 9.5x25.5x6      | 17.5x29x26      | 0.013       | 72 (x2)          |

Detergent - Transparent

Compatible with the product 419295



**419295**

**Wipes "Fast & Clean"**



| Ply | Sheets per piece | Sheet height | Sheet length | Folded dimensions | Case dimensions | Case volume | Packs per case | Cases per pallet |
|-----|------------------|--------------|--------------|-------------------|-----------------|-------------|----------------|------------------|
| n°  | n°               | cm           | cm           | cm                | cm              | m³          | n°             | n°               |
| 2   | 100              | 33.25        | 21.6         | 16.6x10.8         | 55x18.1x40.5    | 0.040       | 20             | 24 (x2)          |

Pure cellulose - White

Compatible with the product 419277





HOSPITAL  
**CANTEEN**  
DINING AREA

**TAILORED**  
**SOLUTION**  
HYGIENE BEST PRACTICES



4

**417194**

**Interfolded Napkins  
Dispenser Basic**



| Pieces per pack | Dispenser height | Dispenser length | Dispenser width | Capacity    | Case dimensions | Case volume    | Cases per pallet |
|-----------------|------------------|------------------|-----------------|-------------|-----------------|----------------|------------------|
| n°              | cm               | cm               | cm              | -           | cm              | m <sup>3</sup> | n°               |
| 8               | 12.5             | 17.8             | 11.5            | Max. 1 clip | 37x26.5x25      | 0.025          | 63               |

Antibacterial

Available also:



READY TABLE

**416182**

**Quarter-Fold Napkins  
Interfolded**



| Ply | Sheets per piece | Sheet height | Sheet length | Folded dimensions | Pieces per pack | Case dimensions | Case volume    | Packs per case | Cases per pallet |
|-----|------------------|--------------|--------------|-------------------|-----------------|-----------------|----------------|----------------|------------------|
| n°  | n°               | cm           | cm           | cm                | n°              | cm              | m <sup>3</sup> | n°             | n°               |
| 2   | 110              | 21.6         | 33.2         | 16.6x10.8         | 5               | 40.5x34.8x55    | 0.078          | 8              | 12 (x2)          |

Pure cellulose - White

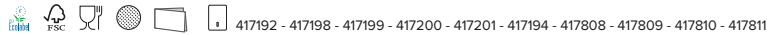

READY TABLE

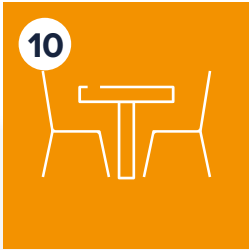

HOSPITAL  
**CANTEEN**  
KITCHEN



**SURFACES WITH A HIGH PROBABILITY OF CONTAMINATION**

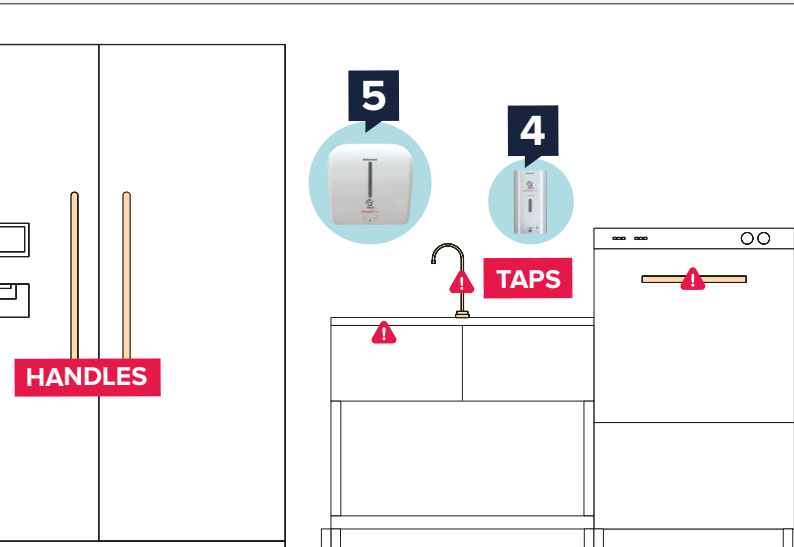

**1**

**CENTREFEED HAND TOWEL DISPENSER**  
Code 416167

Centrefeed paper dispenser optimizes consumption and space.



**HAND TOWEL ROLL CENTREFEED**  
Code 401596

Centrefeed roll, an effective roll to ensure the hygiene of work spaces. Suitable for food contact.



**2**

**WIPES "FAST & CLEAN"**  
Code 419295

Multi-purpose wipes for cleaning any surface and environment. A **practical and fast** solution which guarantees the **maximum level of protection and hygiene** thanks to the **antibacterial additive** present in the packaging.

**SURFACE CLEANER SPRAY**  
Code 419277

Spray cleaner ideal for all surfaces thanks to the action of the **active oxygen and alcohol**.



**3**

**HAND ALCOHOLIC GEL DISPENSER**  
Code 417829

The **antibacterial material**, present in the plastic and not only on the surface, makes it completely safe and helps **decrease the proliferation of germs and bacteria** in the environment.

**HAND ALCOHOLIC GEL**  
Code 417827

Sanitizing gel with **over 70% alcohol**, perfect to guarantee **hand hygiene**.



**4**

**NO TOUCH FOAM SOAP CARTRIDGE DISPENSER**  
Code 419720

Thanks to **automatic dispensing**, the new **No Touch antibacterial dispenser** for soap protects **hand hygiene**, reducing the risk of contamination.

**FOAM SOAP 0,5 LT**  
Code 411209

**FOAM SOAP 1,2 LT**  
Code 419723

Formulated to **reduce the bacterial load on hands** and **guarantee a deep sanitizing action**.



**5**

**UNIVERSUS DISPENSER AUTOMATIC CUTTING SYSTEM (NO ARMS)**  
Code 419271

The only dispenser **compatible with all wiper rolls**. Papernet confirms its ongoing commitment to research and innovation aimed at creating new cleaning solutions for every professional environment. Universus is the brand new dispenser ideally suited for high traffic areas such as public restrooms, commercial kitchens and canteens. **This new and exclusive design fits many types of wiper roll perfectly, keeping refills safe and hygienic.**

**HAND TOWEL ROLLS AUTOCUT**  
Code 412090

Enriched with an **antibacterial formula** which makes it ideal for prolonging the **bacteriostatic action** during hand drying.





HOSPITAL  
**CANTEEN**  
KITCHEN

**TAILORED**  
**SOLUTION**  
HYGIENE BEST PRACTICES



1

416167

**Centrefeed Hand Towel Dispenser**



| Pieces per pack | Dispenser height | Dispenser length | Dispenser width | Capacity            | Case dimensions | Case volume | Cases per pallet |
|-----------------|------------------|------------------|-----------------|---------------------|-----------------|-------------|------------------|
| n°              | cm               | cm               | cm              | -                   | cm              | m³          | n°               |
| 4               | 37.5             | 25.6             | 27.5            | Max. Ø cm 24 x 24 h | 55.5x39x52.5    | 0.114       | 16               |

Antibacterial

**DEFEND+TECH**

401596

**Hand Towel Roll Centrefeed**



| Ply | Sheets per piece | Roll length | Sheet height | Sheet length | Roll diameter | Core diameter | Pieces per pack | Case dimensions | Case volume | Packs per case | Cases per pallet |
|-----|------------------|-------------|--------------|--------------|---------------|---------------|-----------------|-----------------|-------------|----------------|------------------|
| n°  | n°               | mt          | cm           | cm           | cm            | cm            | n°              | cm              | m³          | n°             | n°               |
| 2   | 450              | 137         | 19.7         | 30           | 19.2          | 6             | 6               | 19.7x38.5x58    | 0.044       | 1              | 44               |

Pure cellulose - White

416144 - 417208 - 416167

2

419277

**Surface Cleaner Spray**



| Capacity | Pack per case | Pack dimensions | Case dimensions | Case volume | Cases per pallet |
|----------|---------------|-----------------|-----------------|-------------|------------------|
| ml       | n°            | cm              | cm              | m³          | n°               |
| 750      | 6             | 9.5x25.5x6      | 17.5x29x26      | 0.013       | 72 (x2)          |

Detergent - Transparent

Compatible with the product 419295

**DEFEND+TECH**

419295

**Wipes "Fast & Clean"**



| Ply | Sheets per piece | Sheet height | Sheet length | Folded dimensions | Case dimensions | Case volume | Packs per case | Cases per pallet |
|-----|------------------|--------------|--------------|-------------------|-----------------|-------------|----------------|------------------|
| n°  | n°               | cm           | cm           | cm                | cm              | m³          | n°             | n°               |
| 2   | 100              | 33.25        | 21.6         | 16.6x10.8         | 55x18.1x40.5    | 0.040       | 20             | 24 (x2)          |

Pure cellulose - White

Compatible with the product 419277

**DEFEND+TECH**

3

417829

**Hand Alcoholic Gel Dispenser**



| Pieces per pack | Dispenser height | Dispenser length | Dispenser width | Capacity | Dosage | Case dimensions | Case volume | Cases per pallet |
|-----------------|------------------|------------------|-----------------|----------|--------|-----------------|-------------|------------------|
| n°              | cm               | cm               | cm              | -        | ml     | cm              | m³          | n°               |
| 6               | 22               | 11.6             | 13.9            | 0.50 lt  | 1      | 39x25.5x33      | 0.033       | 54               |

Antibacterial

417827

**DEFEND+TECH**

417827

**Hand Alcoholic Gel**



| Capacity | Pack per case | Pack dimensions | Case dimensions | Case volume | Cases per pallet |
|----------|---------------|-----------------|-----------------|-------------|------------------|
| ml       | n°            | cm              | cm              | m³          | n°               |
| 500      | 12            | 8.8x11.7x8      | 35.9x13x24.2    | 0.011       | 63               |

Gel - Transparent

417829 - 419283 - 419727

**DEFEND+TECH**



HOSPITAL  
**CANTEEN**  
KITCHEN

**TAILORED**  
**SOLUTION**  
HYGIENE BEST PRACTICES



4

**419720**  
**No Touch Foam Soap**  
**Cartridge Dispenser**



| Pieces per pack | Dispenser height | Dispenser length | Dispenser width | Capacity         | Dosage | Case dimensions | Case volume    | Cases per pallet |
|-----------------|------------------|------------------|-----------------|------------------|--------|-----------------|----------------|------------------|
| n°              | cm               | cm               | cm              | -                | ml     | cm              | m <sup>3</sup> | n°               |
| 1               | 25               | 12               | 13.5            | 0.50 lt - 1.2 lt | 0.7    | 14.5x26x13.8    | 0.005          | 216              |

Antibacterial

411209 - 419723



**411209**  
**Foam Soap**



| Capacity | Pack per case | Pack dimensions | Case dimensions | Case volume    | Cases per pallet |
|----------|---------------|-----------------|-----------------|----------------|------------------|
| ml       | n°            | cm              | cm              | m <sup>3</sup> | n°               |
| 500      | 12            | 8.8x11.7x8      | 35.9x13x24.2    | 0.011          | 63               |

Foam Soap - Transparent

416150 - 417206 - 419720

**419723**  
**Foam Soap**



| Capacity | Pack per case | Pack dimensions | Case dimensions | Case volume    | Cases per pallet |
|----------|---------------|-----------------|-----------------|----------------|------------------|
| ml       | n°            | cm              | cm              | m <sup>3</sup> | n°               |
| 1200     | 6             | 12x15.5x10      | 18x25x32.5      | 0.014          | 54 (x1)          |

Foam Soap - Transparent

419720

5

**419271**  
**Universus Dispenser**  
**Automatic**  
**Cutting System (No Arms)**



| Pieces per pack | Dispenser height | Dispenser length | Dispenser width | Capacity            | Case dimensions | Case volume    | Cases per pallet |
|-----------------|------------------|------------------|-----------------|---------------------|-----------------|----------------|------------------|
| n°              | cm               | cm               | cm              | -                   | cm              | m <sup>3</sup> | n°               |
| 1               | 33.3             | 32.1             | 22.6            | Max. ø cm 20 x 22 h | 36x34x25.3      | 0.030          | 48               |

Antibacterial



**412090**  
**Hand Towel Rolls**  
**Autocut**



| Ply | Sheets per piece | Roll length | Sheet height | Sheet length | Roll diameter | Core diameter | Pieces per pack | Case dimensions | Case volume    | Packs per case | Cases per pallet |
|-----|------------------|-------------|--------------|--------------|---------------|---------------|-----------------|-----------------|----------------|----------------|------------------|
| n°  | n°               | mt          | cm           | cm           | cm            | cm            | n°              | cm              | m <sup>3</sup> | n°             | n°               |
| 2   | 1                | 140         | 19.8         | 14000        | 18.5          | 3.9           | 6               | 55.5x19.8x37    | 0.041          | 1              | 44               |

Pure cellulose - White

416155 - 417209





## HOSPITAL COFFEE SHOP



**SURFACES WITH A HIGH PROBABILITY OF CONTAMINATION**

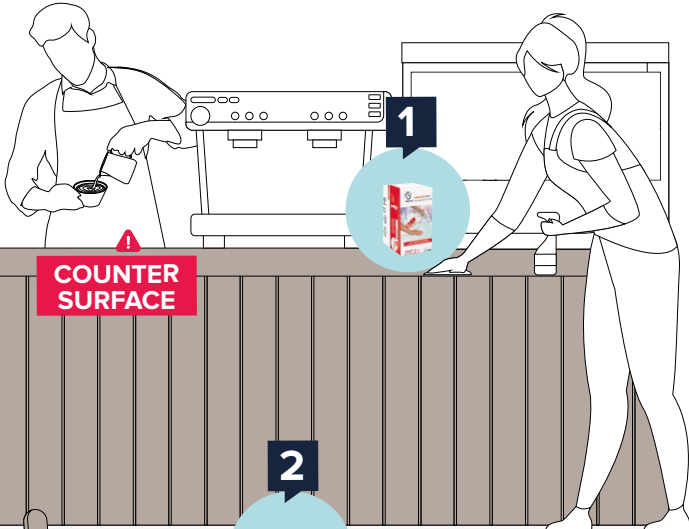
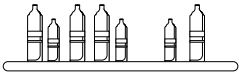

**COUNTER SURFACE**

**2**

**TABLES**

**CHAIRS**

**1**

### WIPES "FAST & CLEAN" Code 419295

Multi-purpose wipes for cleaning any surface and environment. A **practical and fast** solution which guarantees the **maximum level of protection and hygiene** thanks to the **antibacterial additive** present in the packaging.



### SURFACE CLEANER SPRAY Code 419277

Spray cleaner ideal for all surfaces thanks to the action of the **active oxygen and alcohol**.

**2**

### INTERFOLDED NAPKINS BASIC Code 417810



The **antibacterial material**, present in the plastic and not only on the surface, makes it completely safe and helps **decrease the proliferation of germs and bacteria** in the environment.

Available colours



### HALF-FOLD NAPKINS INTERFOLDED Code 416194

The **antibacterial additive** in the poly guarantees a greater **protection from external contamination agents** while the **easy opening** allows a single napkin to be taken.



# HOSPITAL COFFEE SHOP

**TAILORED  
SOLUTION**  
HYGIENE BEST PRACTICES



1

**419277**  
**Surface Cleaner  
Spray**



| Capacity | Pack per case | Pack dimensions | Case dimensions | Case volume    | Cases per pallet |
|----------|---------------|-----------------|-----------------|----------------|------------------|
| ml       | n°            | cm              | cm              | m <sup>3</sup> | n°               |
| 750      | 6             | 9.5x25.5x6      | 17.5x29x26      | 0.013          | 72 (x2)          |

Detergent - Transparent

Compatible with the product 419295



**419295**  
**Wipes "Fast & Clean"**



| Ply | Sheets per piece | Sheet height | Sheet length | Folded dimensions | Case dimensions | Case volume    | Packs per case | Cases per pallet |
|-----|------------------|--------------|--------------|-------------------|-----------------|----------------|----------------|------------------|
| n°  | n°               | cm           | cm           | cm                | cm              | m <sup>3</sup> | n°             | n°               |
| 2   | 100              | 33.25        | 21.6         | 16.6x10.8         | 55x18.1x40.5    | 0.040          | 20             | 24 (x2)          |

Pure cellulose - White

Compatible with the product 419277



2

**417810**  
**Interfolded Napkins  
Dispenser Basic**



| Pieces per pack | Dispenser height | Dispenser length | Dispenser width | Capacity    | Case dimensions | Case volume    | Cases per pallet |
|-----------------|------------------|------------------|-----------------|-------------|-----------------|----------------|------------------|
| n°              | cm               | cm               | cm              | -           | cm              | m <sup>3</sup> | n°               |
| 8               | 12.5             | 17.8             | 11.5            | Max. 1 clip | 37x26.5x25      | 0.025          | 63               |

Antibacterial

Available also:

Red Orange White Black



**416194**  
**Half-Fold Napkins  
Interfolded**



| Ply | Sheets per piece | Sheet height | Sheet length | Folded dimensions | Pieces per pack | Case dimensions | Case volume    | Packs per case | Cases per pallet |
|-----|------------------|--------------|--------------|-------------------|-----------------|-----------------|----------------|----------------|------------------|
| n°  | n°               | cm           | cm           | cm                | n°              | cm              | m <sup>3</sup> | n°             | n°               |
| 2   | 224              | 21.6         | 16.6         | 16.6x10.8         | 1               | 34.8x55x40.5    | 0.078          | 8              | 12 (x2)          |

Pure cellulose - White

417192 - 417198 - 417199 - 417200 - 417201 - 417194 - 417808 - 417809 - 417810 - 417811



MEDICAL CLINIC  
**CONSULTATION ROOM**



|   |      |        |
|---|------|--------|
| Medical Rolls Defend Tech                             | Code | 419719 |
| Facial Tissue Dissolve Tech                           | Code | 411173 |
| Facial Tissue   | Code | 419583 |
| Facial Tissue   | Code | 419588 |
| No Touch Liquid Soap Refillable Dispenser Defend Tech | Code | 419721 |
| Liquid Soap 5 Lt                                      | Code | 413123 |
| Liquid Soap Dispenser Defend Tech                     | Code | 416151 |
| Antimicrobial Soap Defend Tech                        | Code | 411210 |
| Medical Rolls Defend Tech                             | Code | 419287 |

HOSPITAL  
**WASHROOM**



|   |      |        |
|---|------|--------|
| No Touch Liquid Soap Refillable Dispenser Defend Tech     | Code | 419721 |
| Liquid Soap 5 Lt  | Code | 413123 |
| C/V - Fold Hand Towel Antibacterial Dispenser Defend Tech | Code | 416143 |
| V - Folded Hand Towel Dissolve Tech                       | Code | 411169 |
| V - Folded Hand Towel Bio Tech                            | Code | 407572 |
| Hand Towel Rolls Autocut Dissolve Tech                    | Code | 416598 |
| Toilet Tissue Interfolded Bio Tech                        | Code | 407571 |
| Toilet Tissue Maxi Jumbo Dissolve Tech                    | Code | 416163 |
| Hand Towel Rolls Autocut Defend Tech                      | Code | 412090 |

HOSPITAL  
**CANTEEN KITCHEN**



|  |      |        |
|--|------|--------|
| Hand Towel Rolls Autocut Dry Tech            | Code | 407558 |
| Hand Towel Rolls Autocut Dry Tech            | Code | 416623 |
| Hand Towel Rolls Centrefeed Papernet No Tech | Code | 412056 |
| Wiper Rolls Industrial Dry Tech              | Code | 407547 |
| Mini Autocut Dispenser Defend Tech           | Code | 416155 |

HOSPITAL  
**CANTEEN DINING AREA**



|   |      |        |
|---|------|--------|
| Napkins 33x33 Ready Table - White                         | Code | 400710 |
| Napkins 38x38 Ready Table - White                         | Code | 404270 |
| Napkins 38x38 Ready Table - White                         | Code | 415227 |
| Napkins 38x38 Ready Table - Orange                        | Code | 415215 |
| Napkins 38x38 Ready Table - Bordeaux                      | Code | 415216 |
| Napkins 38x38 Ready Table - Yellow                        | Code | 415217 |
| Napkins 38x38 Ready Table - Red                           | Code | 415218 |
| Napkins 38x38 Ready Table - Champagne                     | Code | 415219 |
| Napkins 38x38 Ready Table - Green                         | Code | 415220 |
| Napkins 38x38 Ready Table - Blue                          | Code | 415221 |
| Napkins 38x38 Ready Table - Lime                          | Code | 415222 |
| Napkins 38x38 Ready Table - Brown                         | Code | 415223 |
| Napkins 38x38 Ready Table - Black                         | Code | 415224 |
| Bar Napkins   | Code | 415242 |
| Quarter-Fold Napkins Interfolded Ready Table              | Code | 416181 |
| Quarter-Fold Napkins Interfolded Ready Table              | Code | 416182 |
| Quarter-Fold Napkins Interfolded Ready Table              | Code | 416187 |
| Quarter-Fold Napkins Interfolded Ready Table              | Code | 416188 |
| Quarter-Fold Napkins Interfolded Ready Table              | Code | 416191 |
| Quarter-Fold Napkins Interfolded Ready Table              | Code | 416192 |
| Half-Fold Napkins Interfolded Ready Table                 | Code | 416183 |
| Half-Fold Napkins Interfolded Ready Table                 | Code | 416184 |
| Half-Fold Napkins Interfolded Ready Table                 | Code | 416189 |
| Half-Fold Napkins Interfolded Ready Table                 | Code | 416190 |
| Half-Fold Napkins Interfolded Ready Table                 | Code | 416193 |
| Half-Fold Napkins Interfolded Ready Table                 | Code | 416194 |
| Interfolded Napkins Dispenser Superior Ready Table Lime   | Code | 417198 |
| Interfolded Napkins Dispenser Superior Ready Table Red    | Code | 417199 |
| Interfolded Napkins Dispenser Superior Ready Table Orange | Code | 417200 |
| Interfolded Napkins Dispenser Superior Ready Table Black  | Code | 417210 |
| Interfolded Napkins Dispenser Basic Ready Table Red       | Code | 417808 |
| Interfolded Napkins Dispenser Basic Ready Table Orange    | Code | 417809 |
| Interfolded Napkins Dispenser Basic Ready Table Lime      | Code | 417810 |
| Interfolded Napkins Dispenser Basic Ready Table Black     | Code | 417811 |

HOSPITAL  
**CHANGING ROOM**



|   |      |        |
|---|------|--------|
| No Touch Liquid Soap Refillable Dispenser Defend Tech | Code | 419721 |
| Liquid Soap 5 Lt                                      | Code | 413123 |



# TAILORED SOLUTION

HYGIENE BEST PRACTICES

